

**LE PRÉAU D'UN SEUL**

LFKs - Jean Michel Bruy **05-01-2010**

HELLERAU - EZK - Dresden

Avril 2010

## **LFKs**

**Thierry Arredondo**

**Goo Bâ**

**Hannes Braun**

**Martine Brunott**

**Gilles Bruyère**

**Jean Michel Bruyère**

**Richard Castelli**

**Laurent Dailleau**

**Florence Drachsler**

**Nadine Febvre**

**Issa Samb**

**Delphine Varas**

**+**

## **Get Sound**

**Charles-Edouard de Surville**

**Rodrigo Sanz**

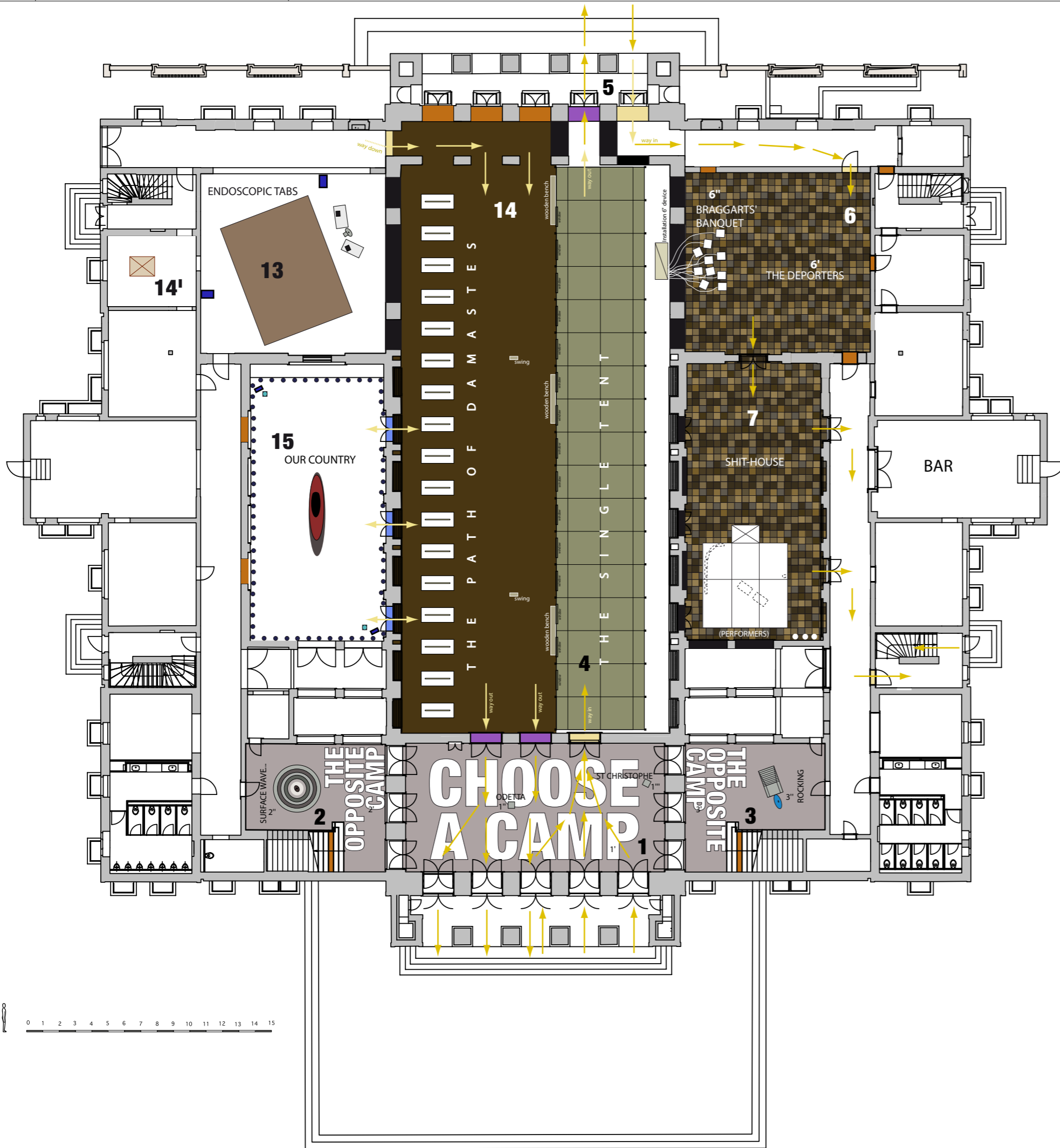

- 1. Choose a Camp**
  - letters painted on the floor (1')
  - 1 video monitor + sound system (1")
  - sculpture (1")
  - 1 dvd player
- 2. Surface Wave Damping**
  - letters painted on the floor (2')
  - sculpture - installation (2")
- 3. Rocking**
  - letters painted on the floor (3')
  - sculpture - installation
  - 1 LCD monitor (3")
  - 1 dvd player
- 4. The Single Tent + Performers**
  - deported set
  - cleaning set
  - fashion set
  - medical care set
  - lounge
  - cook set
  - sound system
- 5. Interlude : Move on to Pasture**
  - deported grounds - installation
- 6. The Deporters**
  - video screening on the wall (6')
  - Braggarts Banquet (robotic music) (6")
  - carpet of shit-tiles
  - 1 video projector
  - 1 dvd player
- 7. Shit-House + Performers**
  - white house construction
  - sculptures inside
  - electric fans inside
  - carpet of shit-tiles
- 13. Endoscopic Tabs**
  - 7 tables +9 video monitors
  - pirogue sculpture - installation
  - video screening on the floor
  - 1 video projector
  - 10 dvd players (14')
  - sound system
- 14. The Path of Damastès**
  - 17 medical beds
  - 17 fluo tubes
  - dead leaves floor
  - 2 swings
  - 3 wooden benches
  - robot, sound system, computers (14')
- 15. Our Country**
  - pirogue
  - bonés
  - reflectors
  - shadow
  - 78 Republican guard helmets
  - sound system



**LE PRÉAU D'UN SEUL**  
**LFKs - J. M. BRUYERE**  
**HELLERAU EZK DRESDEN**  
**APRIL 2010**

**1** RST  
**FLOOR**

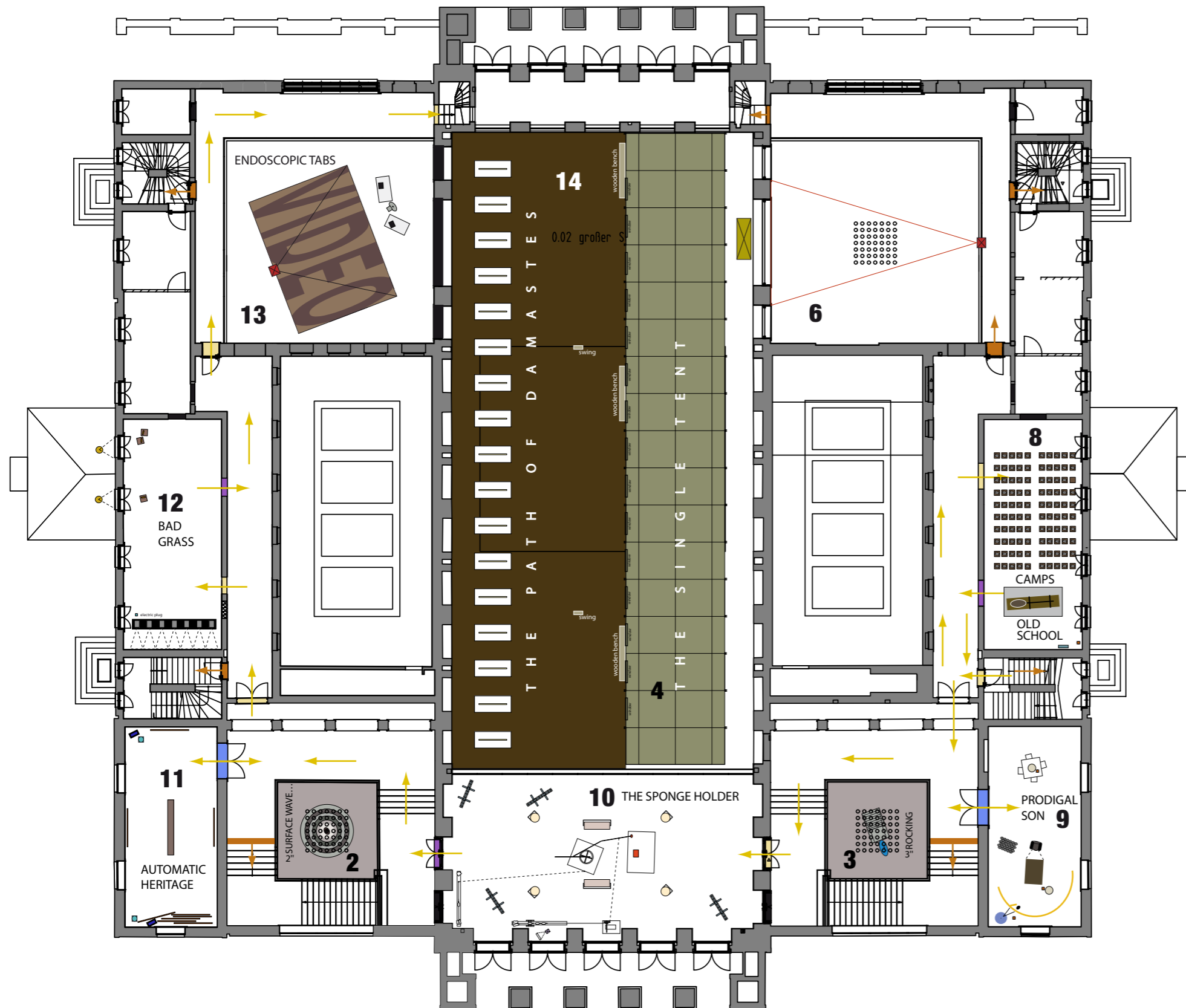

**6. The Deporters**  
 - video screening up on the wall  
 from the gallery (6')

**8. Camps Hold School**  
 - 100 chairs  
 - 100 models of refugee's tent  
 - 1 blackboard  
 - 1 pirogue  
 - pig-iron waves  
 - Bobby Seale's voice (on Revox)  
 - lighting

**9. The Prodigal Son**  
 - sculpture and music- installation  
 - light reflector  
 - Prodigal Son Song

**10. The Sponge Holder**  
 - sculpture installation  
 - sound system and reflectors  
 - paintings  
 - white M1 plastic floor  
 - robot + computer  
 - video projector  
 - dvd player  
 - shutter dmx

**11. Automatic Heritage**  
 - larges paintings on walls  
 - ligths  
 - sound system

**12. Bad Grass**  
 - 7 video screening  
 - sculpture-installation

**13. Endoscopic Tabs**  
 - 7 tables +9 video monitors  
 - pirogue sculpture - installation  
 - video screening on the floor  
 - 1 video projector  
 - 10 dvd players  
 - sound system



**LE PRÉAU D'UN SEUL  
 LFKs - J. M. BRUYERE  
 HELLERAU EZK DRESDEN  
 APRIL 2010**

**2<sup>D</sup>  
 FLOOR**



**Front steps up to First Floor**

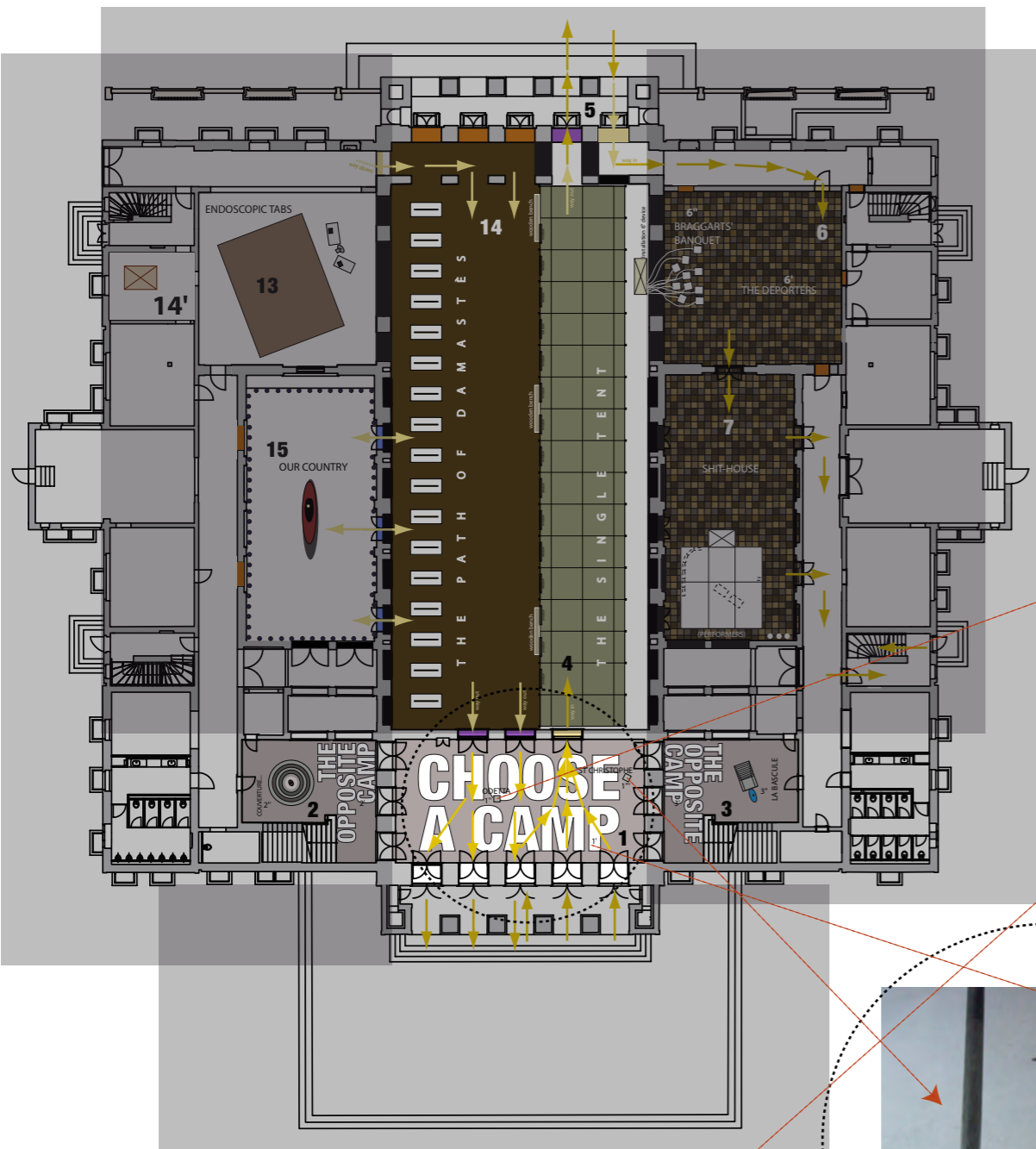

**CHOOSE A CAMP**  
1<sup>ST</sup>

- sound system
- electric plug (monitor + palyer dvd)
- 1' text on the floor
- 1" Odetta + The Earth (vidéo)
- 1" Saint-Christophe de Décathlon (sculpture)



**CHOOSE A CAMP**



Text ("choose a camp"):  
2 options  
- a large sticker on the floor  
- painted with erasable painting

**LE PRÉAU D'UN SEUL**  
LFKs - J. M. BRUYERE  
HELLERAU EZK DRESDEN  
APRIL 2010

**1** RST  
FLOOR

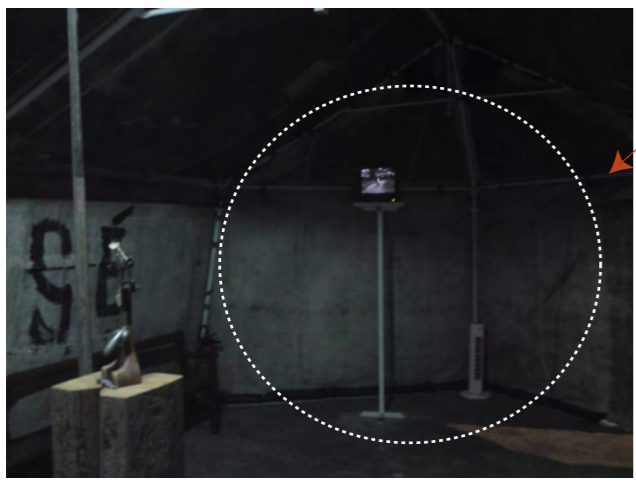



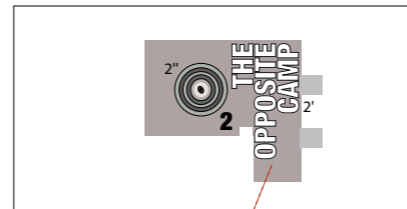
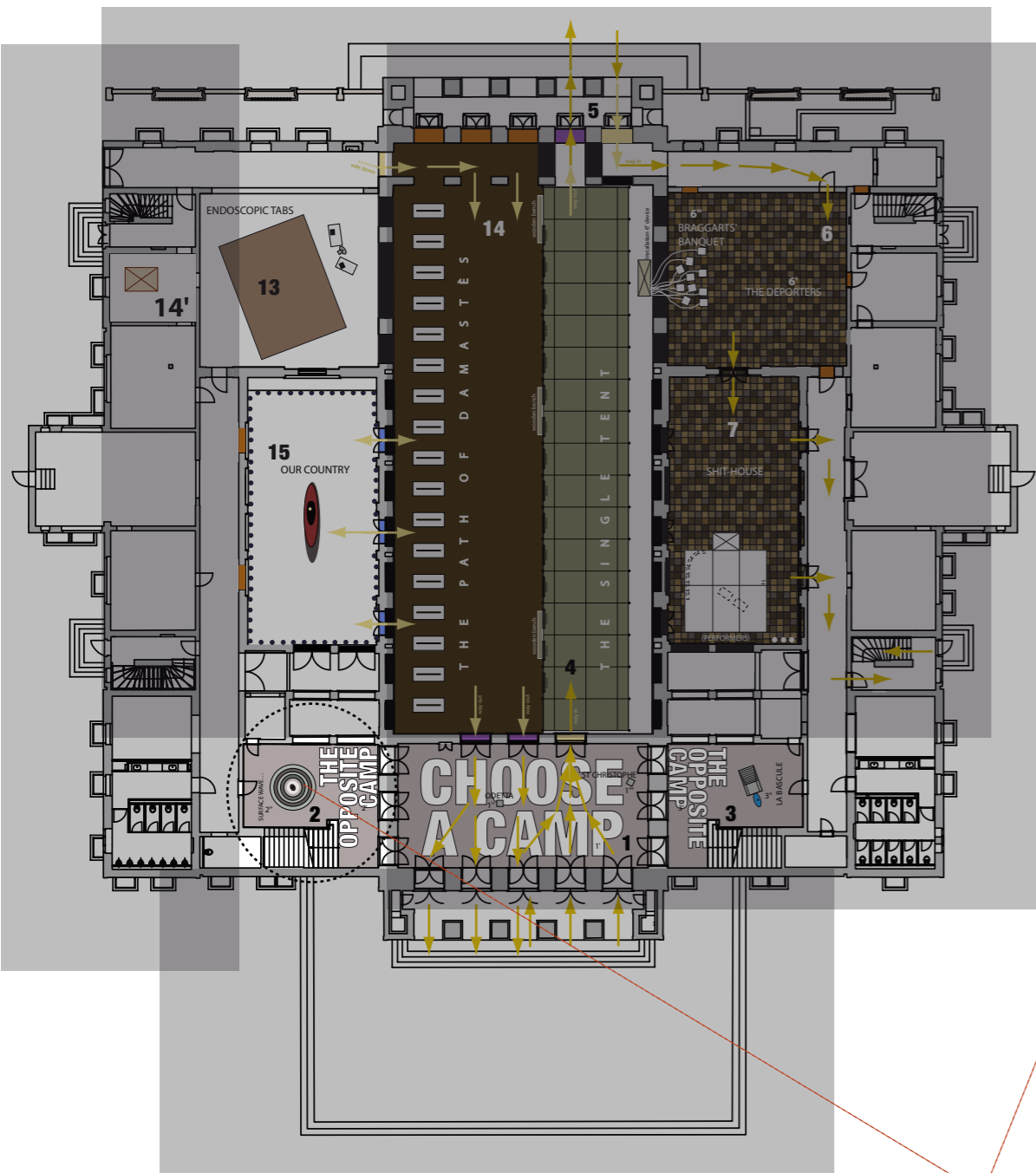

2' text on the floor  
 2" Surface Wave Damping (sculpture)  
 + light reflectors



**SURFACE WAVE DAMPING**

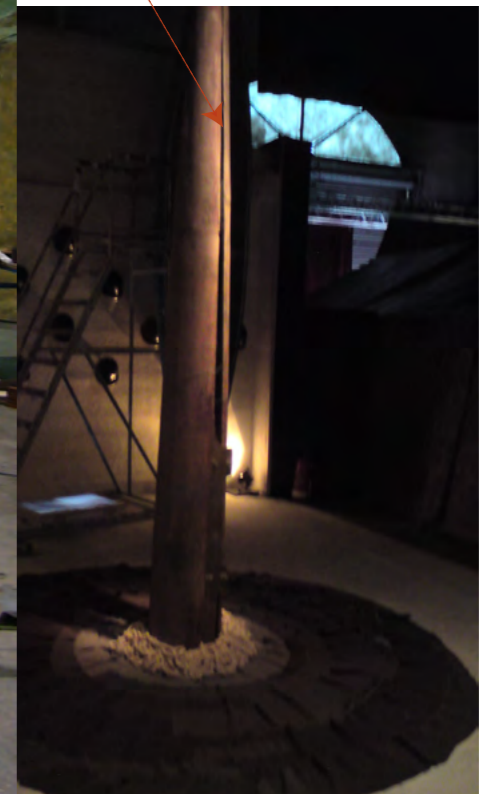

Text ("The opposite camp"):  
 2 options  
 - a large sticker on the floor  
 - painted with erasable painting

**LE PRÉAU D'UN SEUL**  
**LFKs - J. M. BRUYERE**  
**HELLERAU EZK DRESDEN**  
**APRIL 2010**

**1** RST  
**FLOOR**





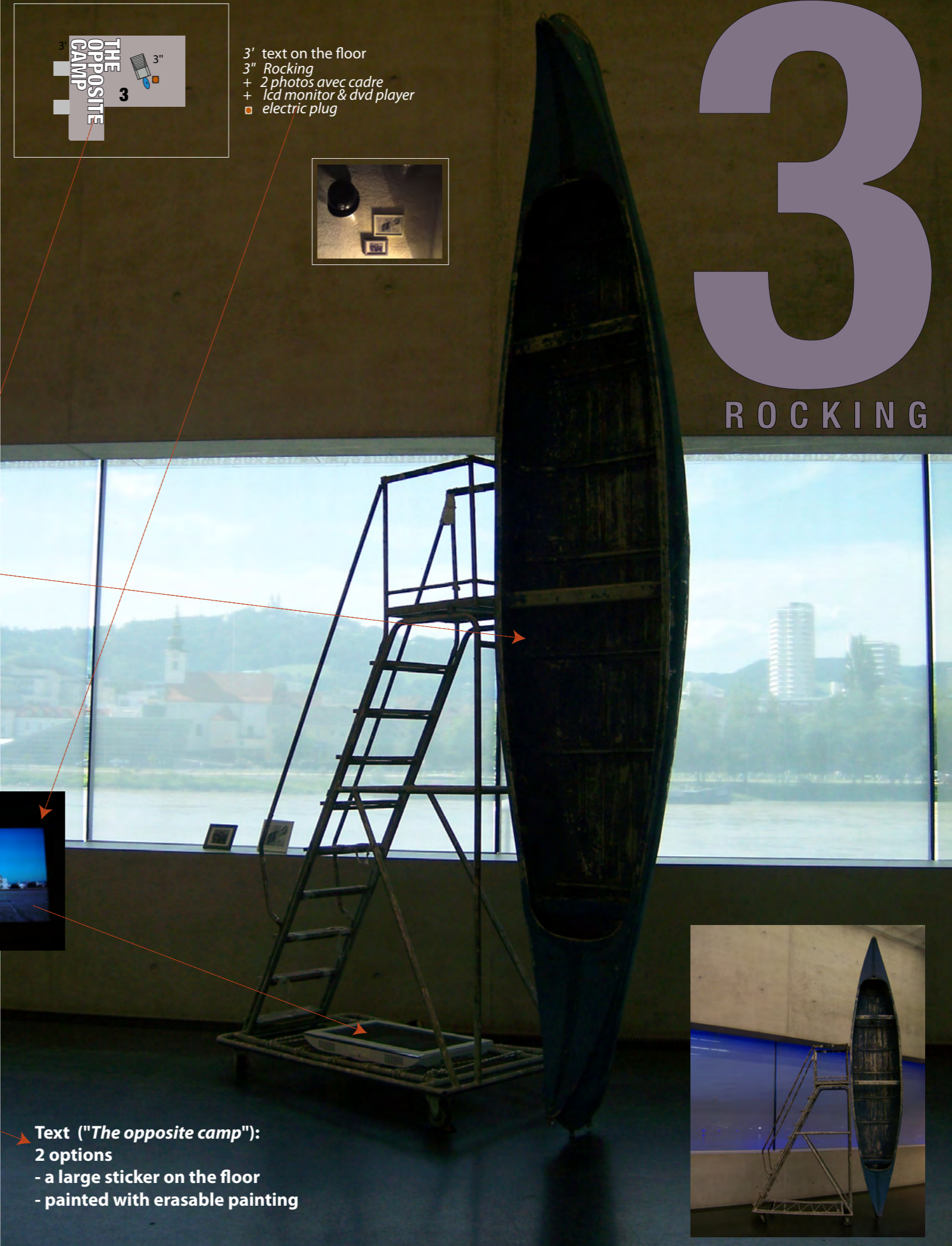
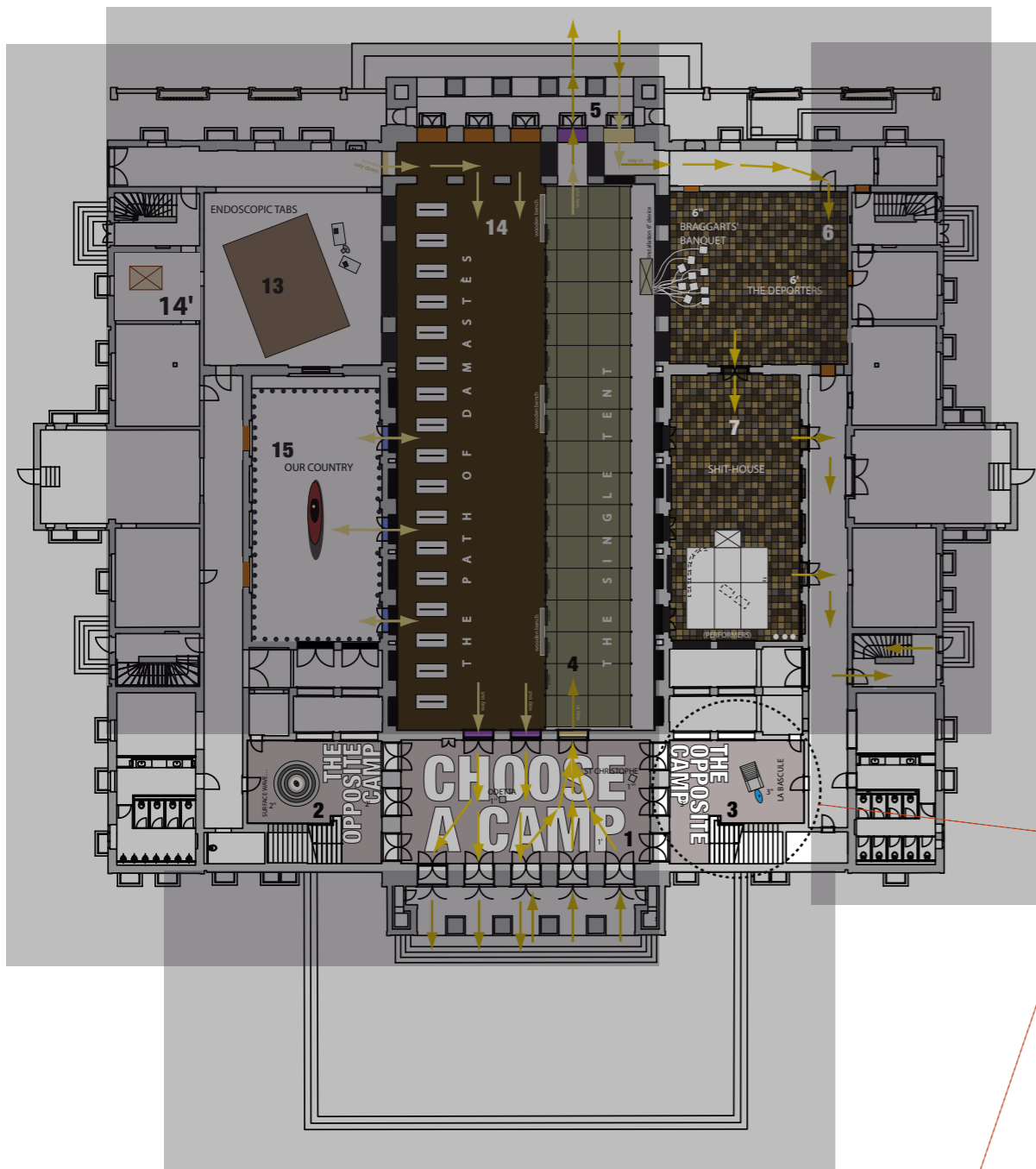

**LE PRÉAU D'UN SEUL**  
**LFKs - J. M. BRUYERE**  
**HELLERAU EZK DRESDEN**  
**APRIL 2010**

**1** RST  
**FLOOR**

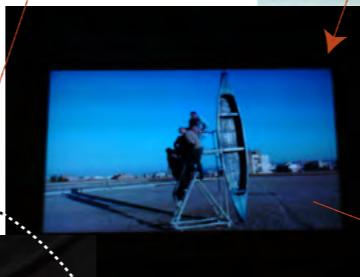

- 3' text on the floor
- 3" Rocking
- + 2 photos avec cadre
- + lcd monitor & dvd player
- electric plug

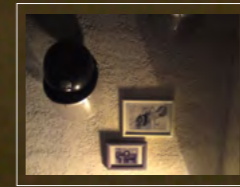

- Text ("The opposite camp"):
- 2 options
- a large sticker on the floor
- painted with erasable painting





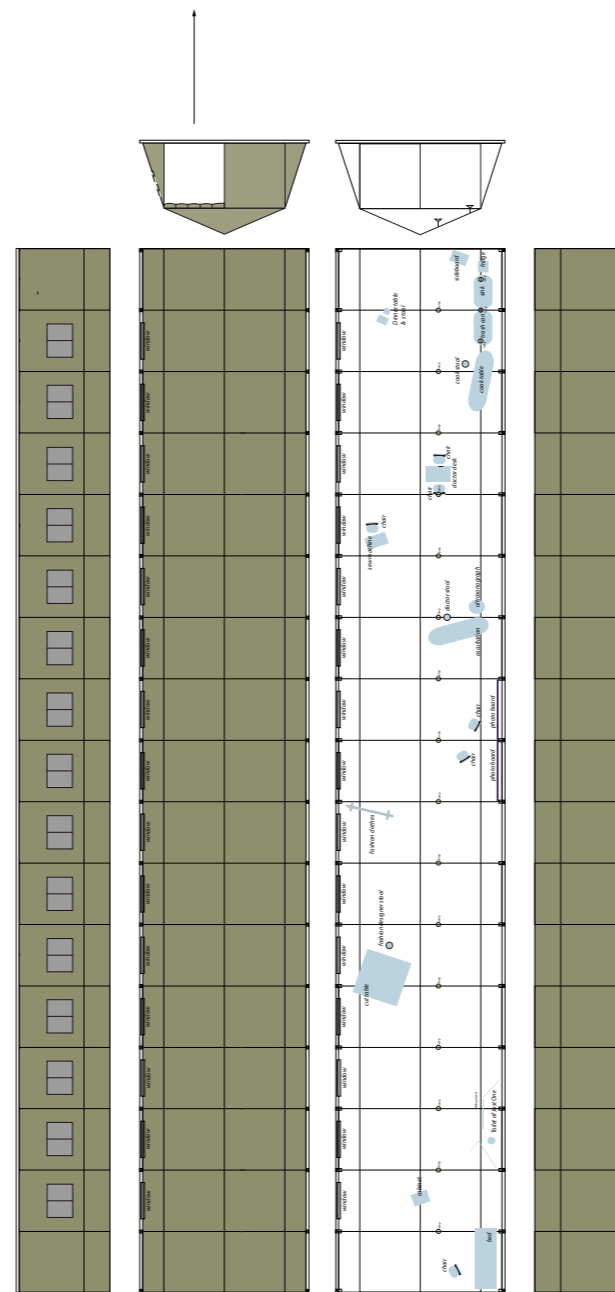
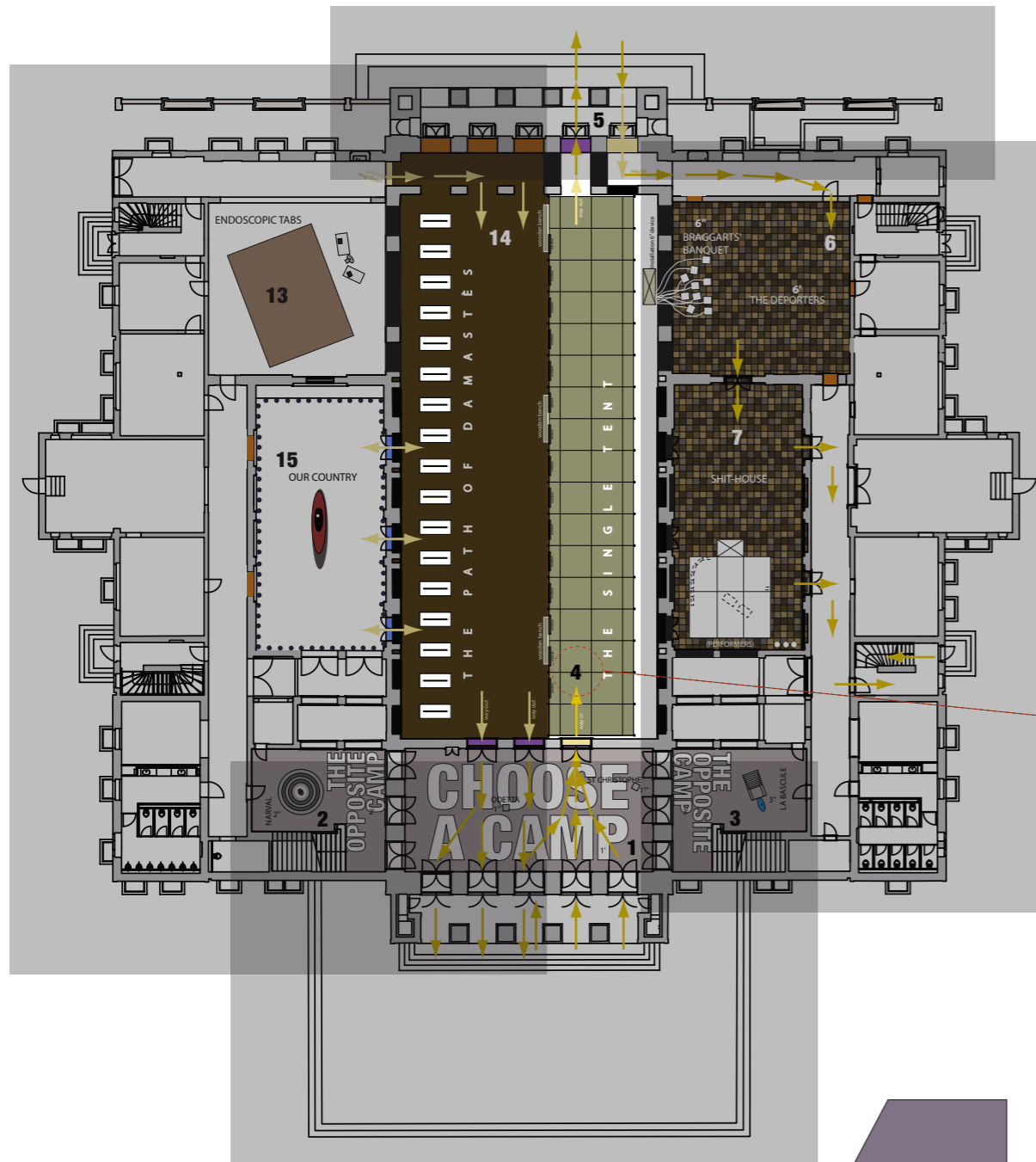

military tent  
540 x 3400 x 300 (thick)  
15 windows

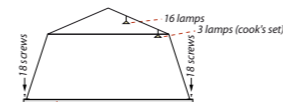
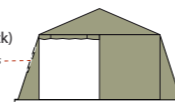

White wooden floor  
(to be provided on location)  
560 x 3400 x 9 cm (thick)

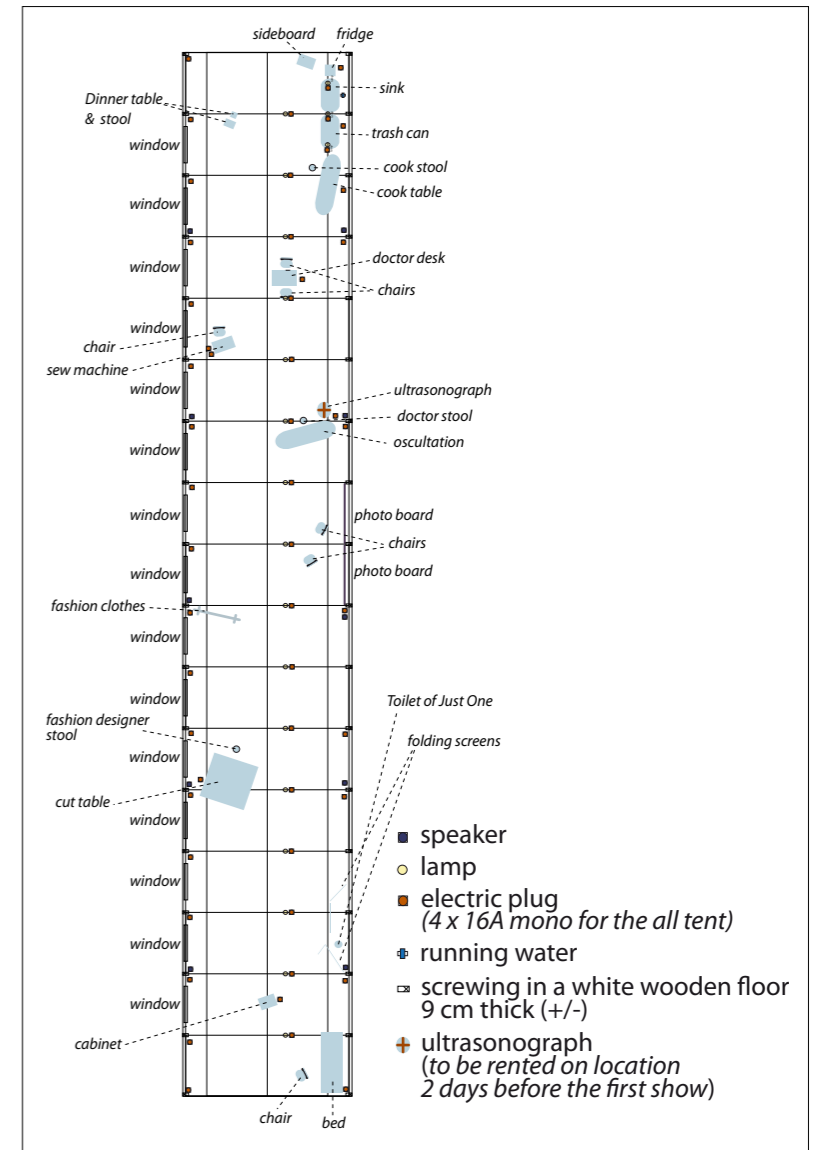

0 1 2 3 4 5 6 7 8 9 10 11 12 13 14 15

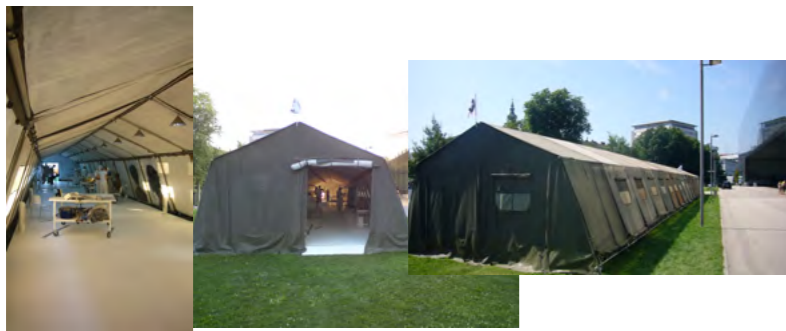

# 4

THE SINGLE TENT



**LE PRÉAU D'UN SEUL**  
**LFKs - J. M. BRUYERE**  
**HELLERAU EZK DRESDEN**  
**APRIL 2010**

**1** RST  
**FLOOR**

**Back door out to back yard**

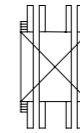
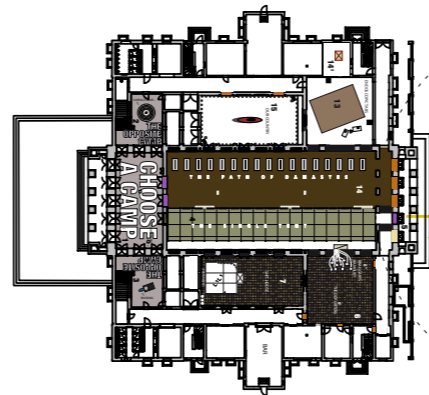
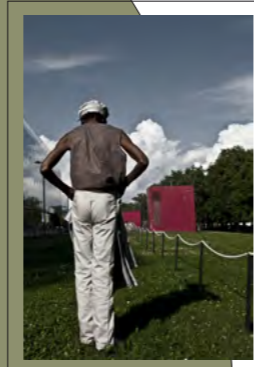
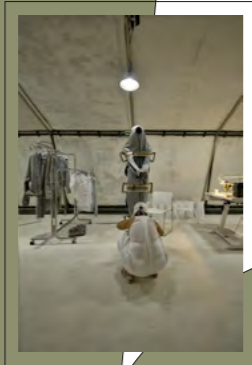

**LE PRÉAU D'UN SEUL**  
LFKS - J. M. BRUYERE  
HELLERAU EZK DRESDEN  
APRIL 2010

**BEHIND**  
THE BUILDING

**INTERLUDE: MOVE ON TO PASTURE**

Deported Grounds

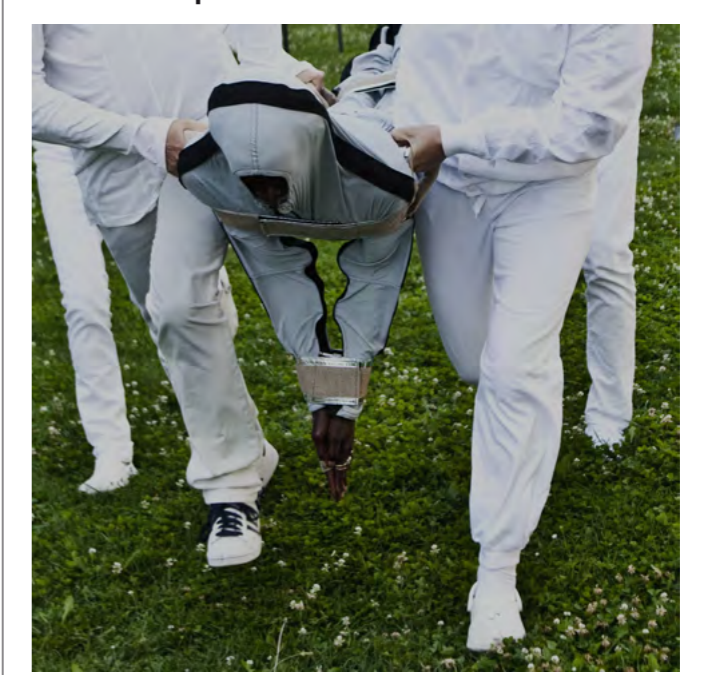

**North-east corridor First Floor to Main hall- side stage east**



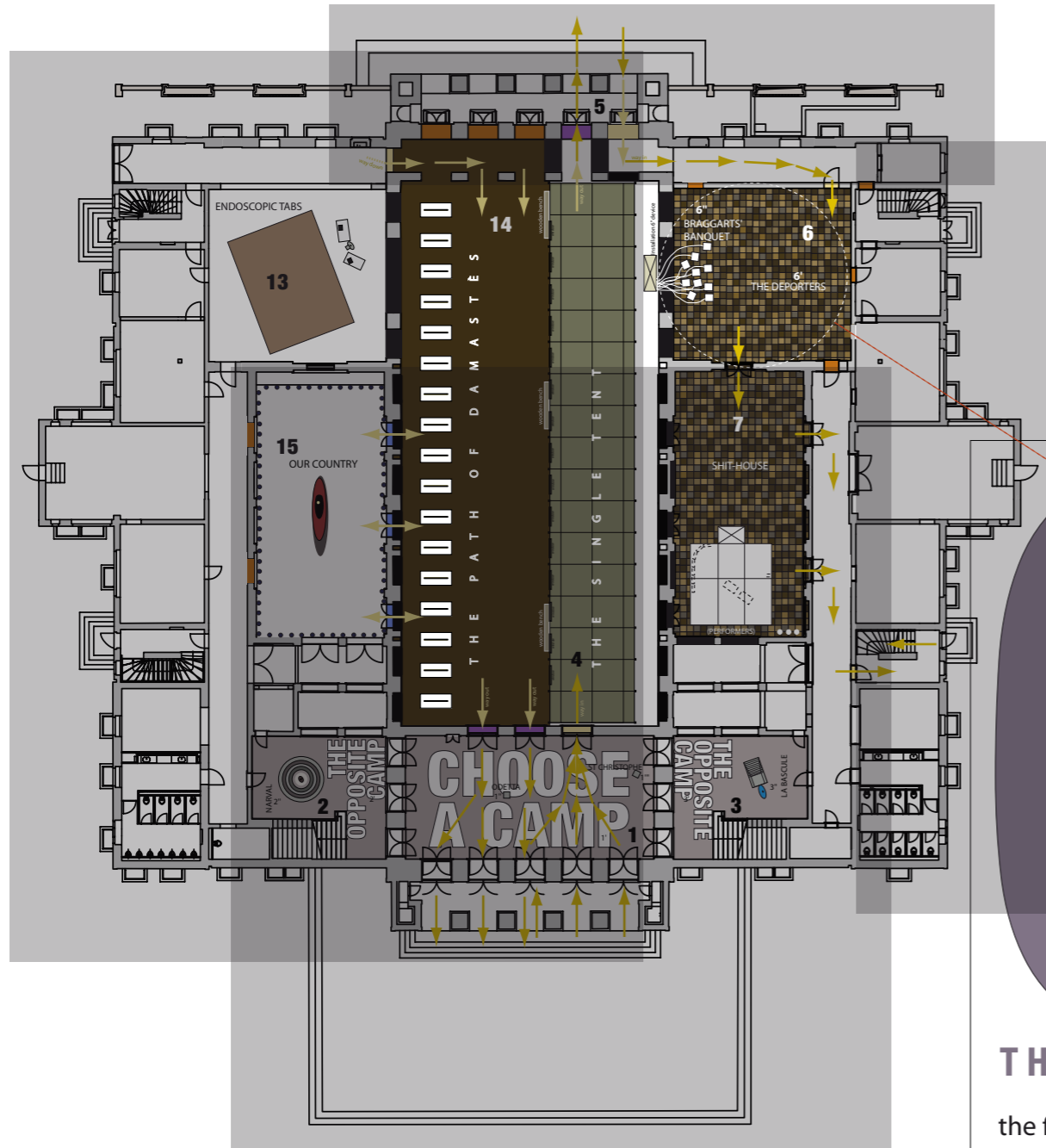

# 6

## THE DEPORTERS

the floor of Room 6 is fully tiled of a shit carpet  
 . each tile size: 50 cm x 50 cm  
 . +/- 500 tiles

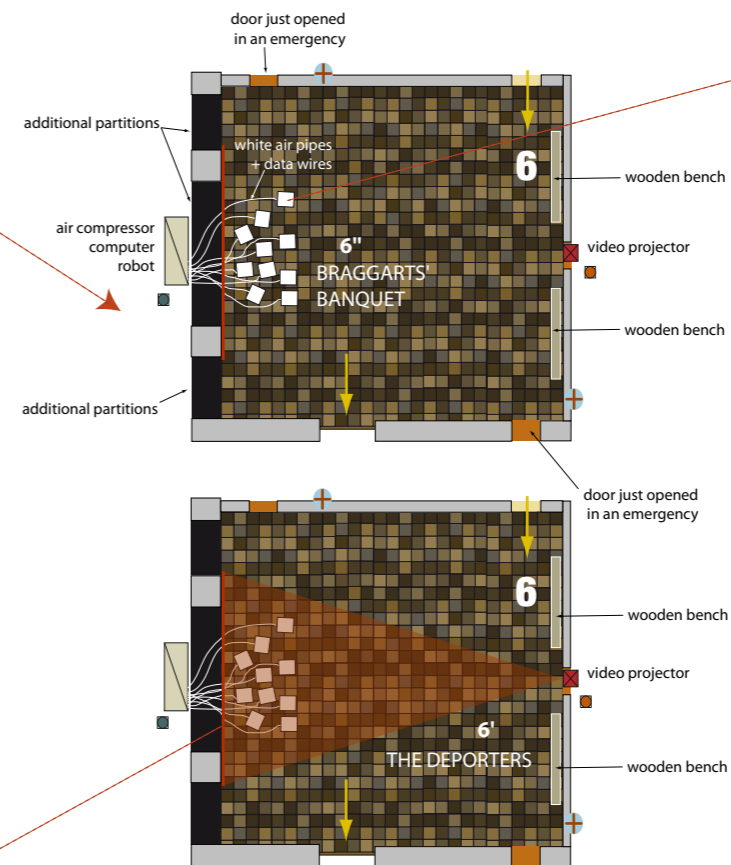

- electric plug (1 x 16A mono)
- electric plug P17 (1 x 16A triphase 3P+N+E)
- ⊕ film sound system
- video projector dvd player sound system base



**LE PRÉAU D'UN SEUL**  
**LFKs - J. M. BRUYERE**  
**HELLERAU EZK DRESDEN**  
**APRIL 2010**

**1** RST  
**FLOOR**

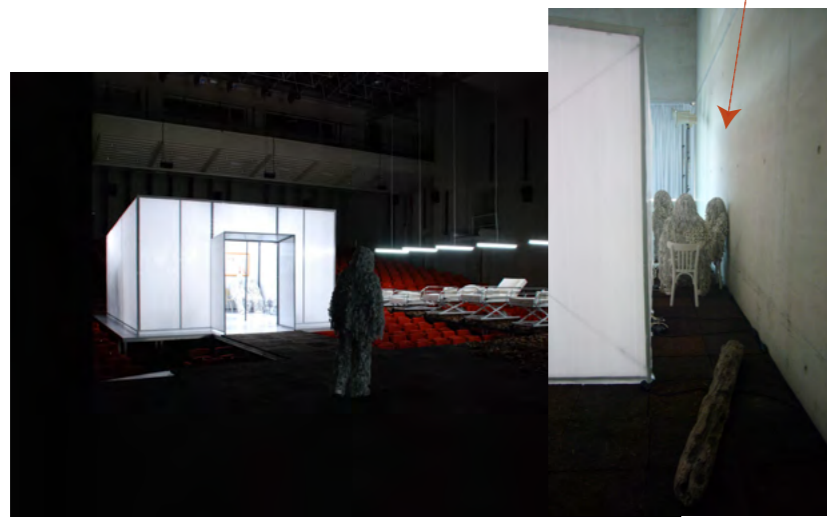
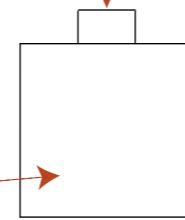
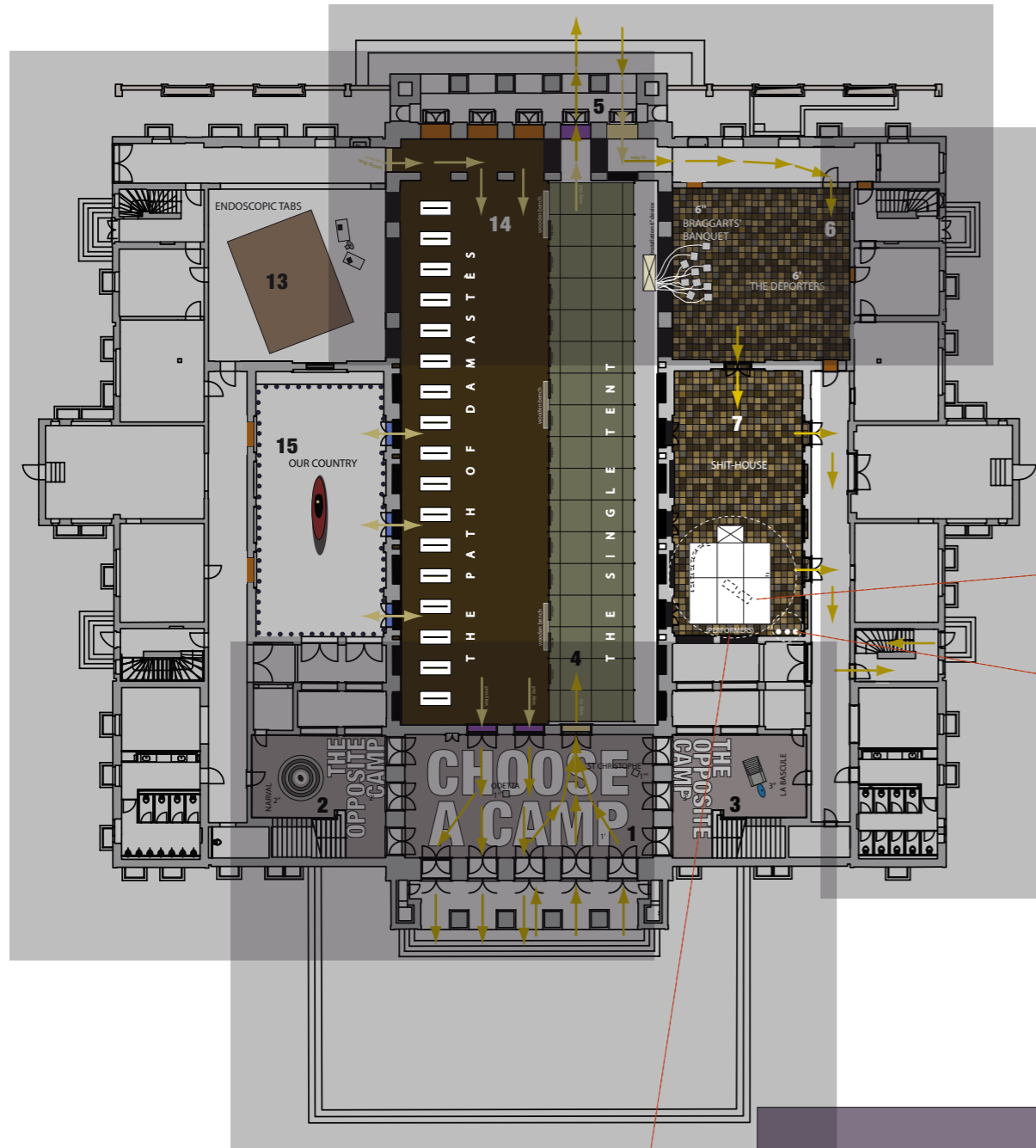

# 7

SHIT-HOUSE

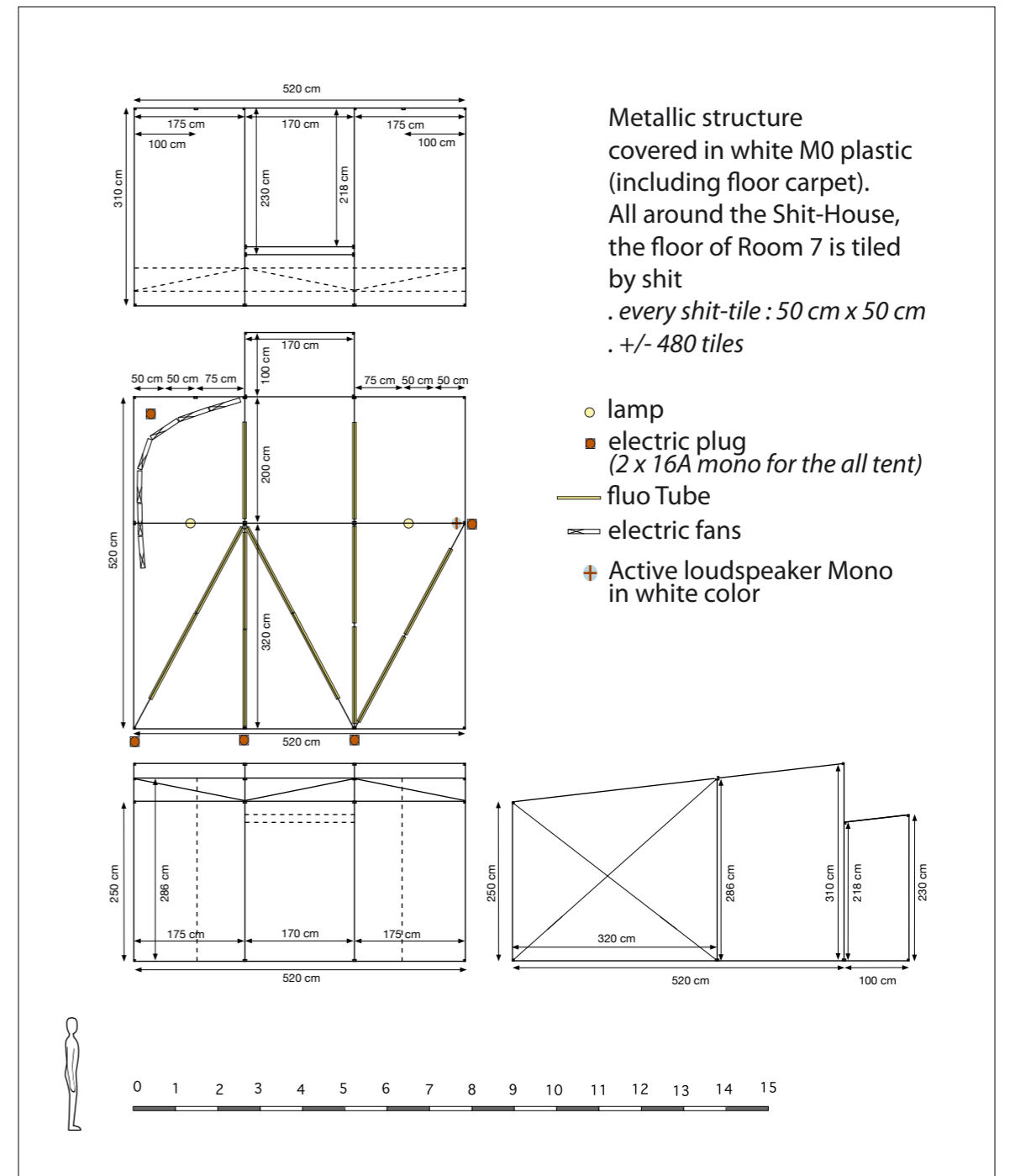

LE PRÉAU D'UN SEUL  
LFKs - J. M. BRUYERE  
HELLERAU EZK DRESDEN  
APRIL 2010

# 1

RST

FLOOR



**East corridor First Floor, stairs up to Second Floor**



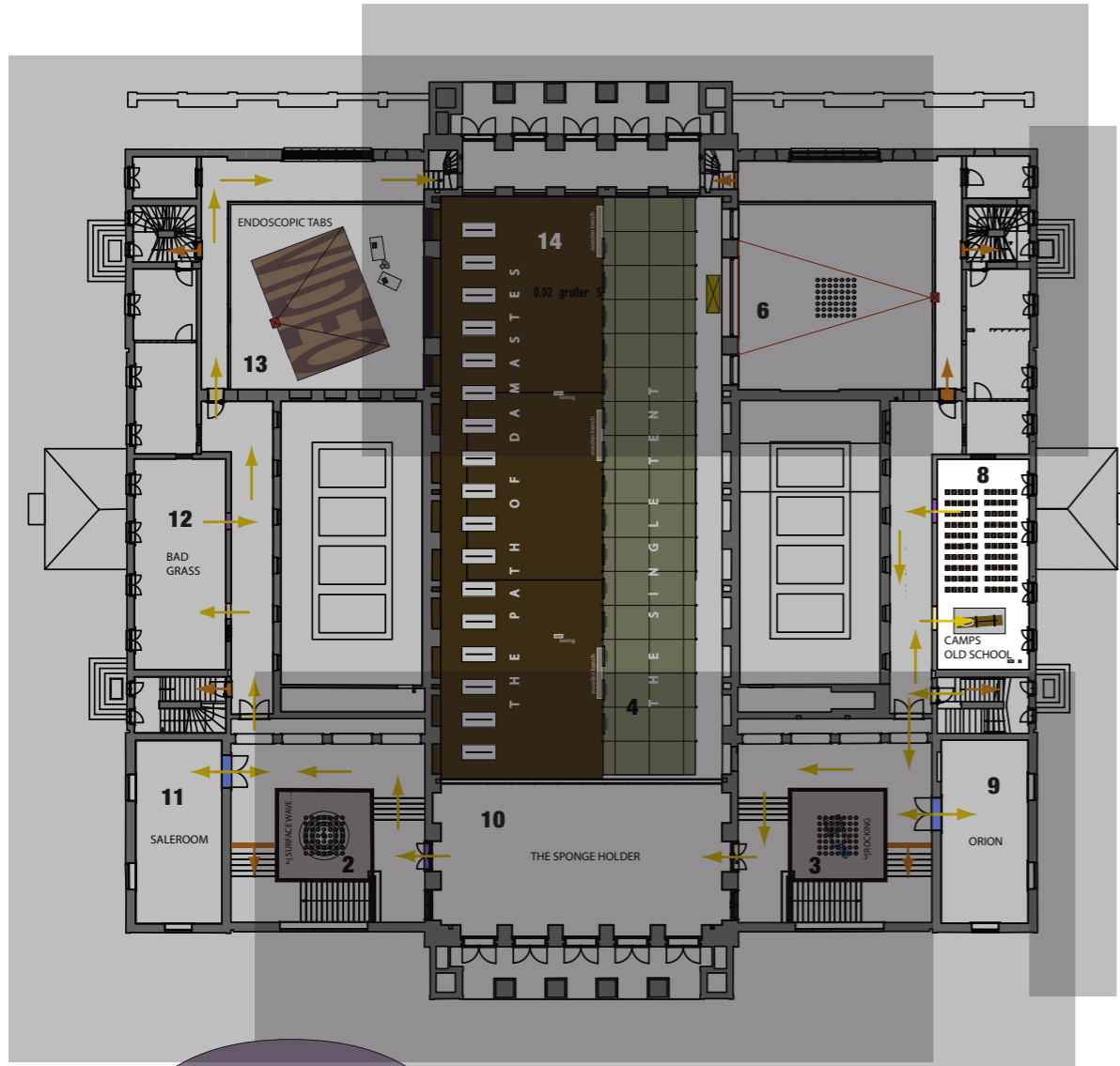

# 8

**LE PRÉAU D'UN SEUL**  
**LFKs - J. M. BRUYERE**  
**HELLERAU EZK DRESDEN**  
**APRIL 2010**

**CAMPS OLD SCHOOL**

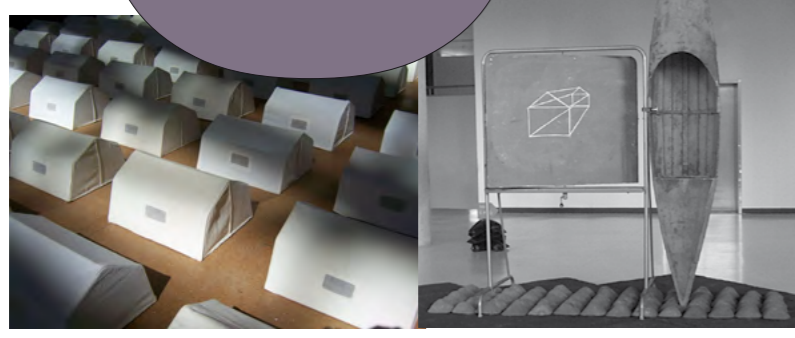

- 8. Camps Hold School**
- 100 chairs
  - 100 models of refugee's tent
  - 1 blackboard
  - 1 pirogue
  - pig-iron waves
  - Bobby Seale's voice
  - light and sound-system

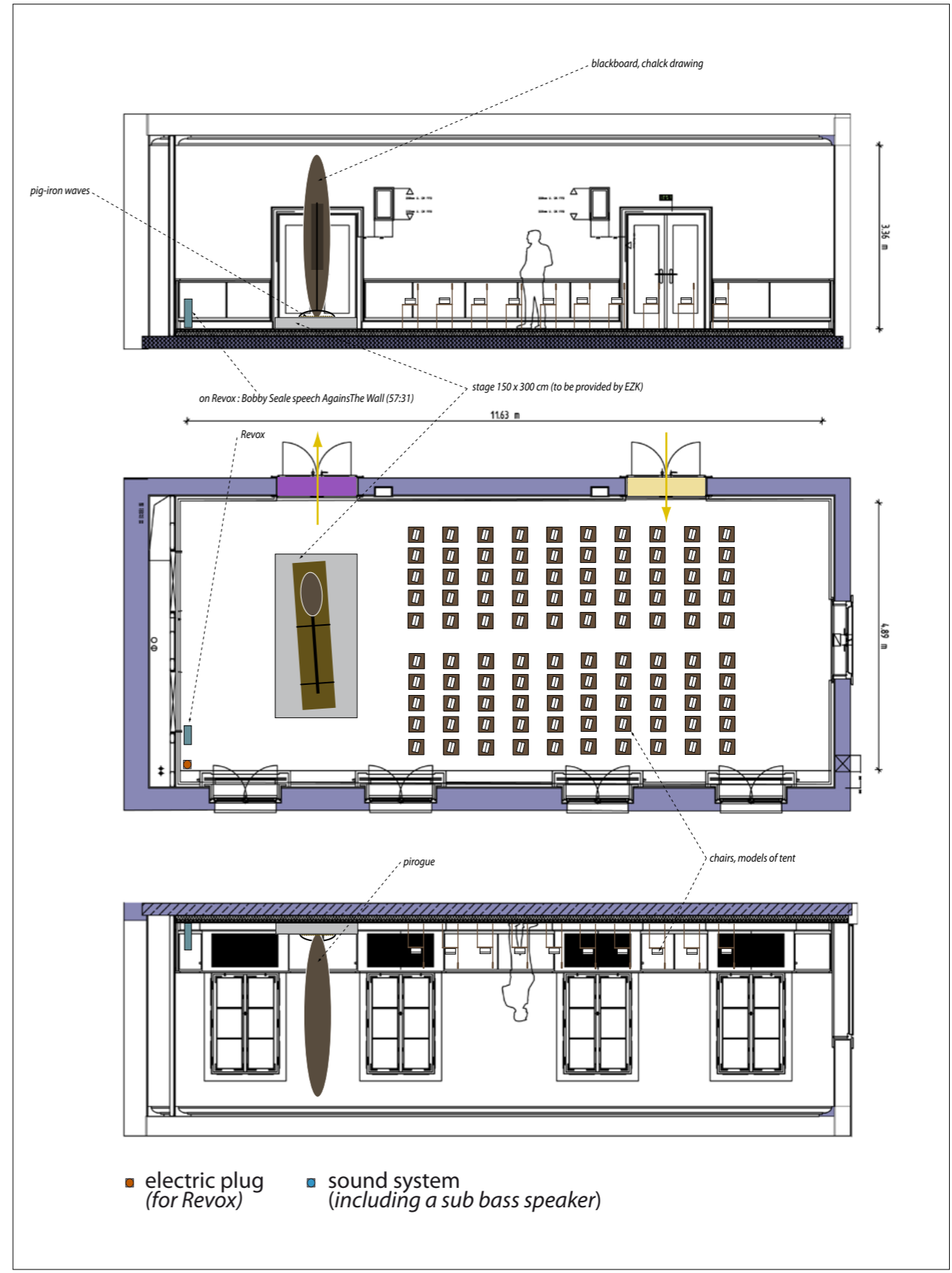

**2<sup>D</sup>**  
**FLOOR**



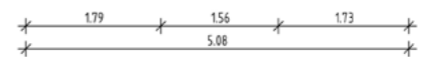
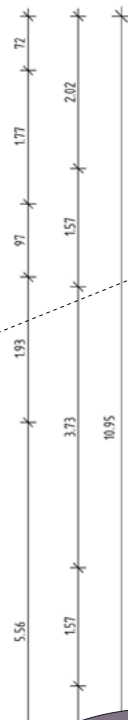
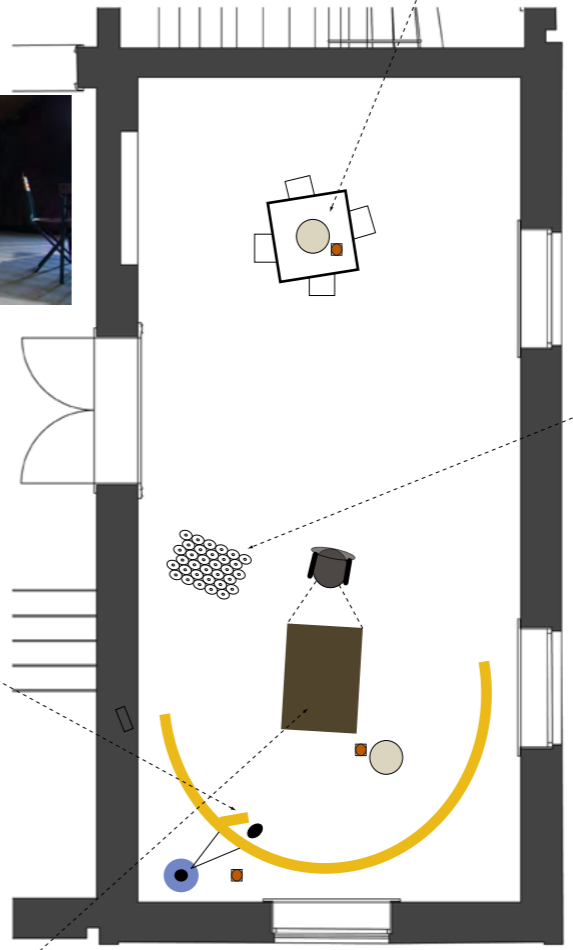
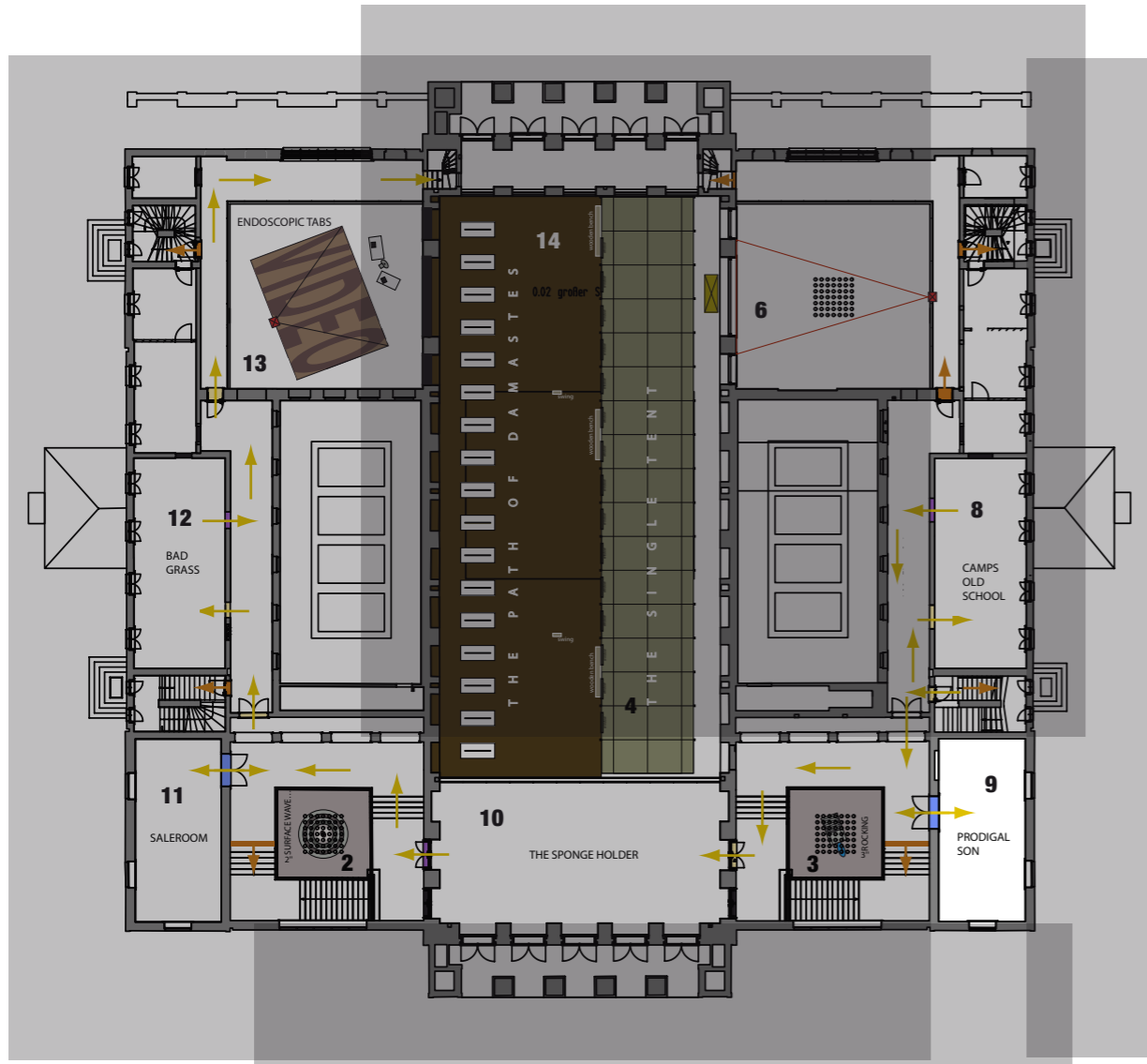

- electric plug (1 x 16A mono)
- light hanging 40 w
- light reflector (on the floor)

9

PRODIGAL SON

**2<sup>D</sup>** FLOOR  
**LE PRÉAU D'UN SEUL**  
 LFKs - J. M. BRUYERE  
 HELLERAU EZK DRESDEN  
 APRIL 2010



**9. The Prodigal Son**  
 - sculpture and music- installation  
 - light reflector  
 - Prodigal Son Song

**East Foyer Second Floor, some stairs up to south Gallery-Main Hall**

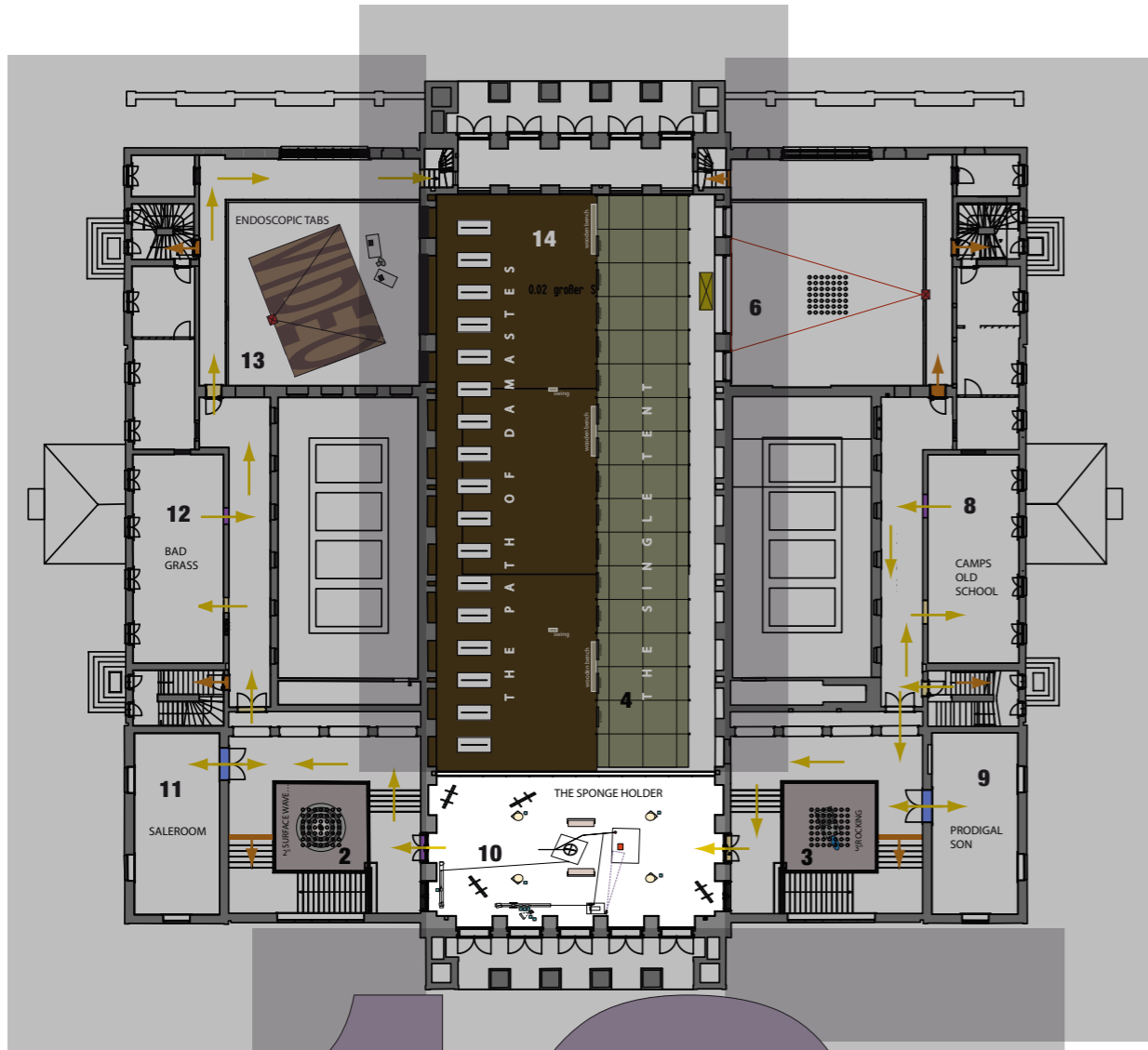

# 10

**LE PRÉAU D'UN SEUL  
LFKs - J. M. BRUYERE  
HELLERAU EZK DRESDEN  
APRIL 2010**

## THE SPONGE HOLDER

**2<sup>D</sup>  
FLOOR**



**West Foyer Second Floor, some stairs down to west Lounge**



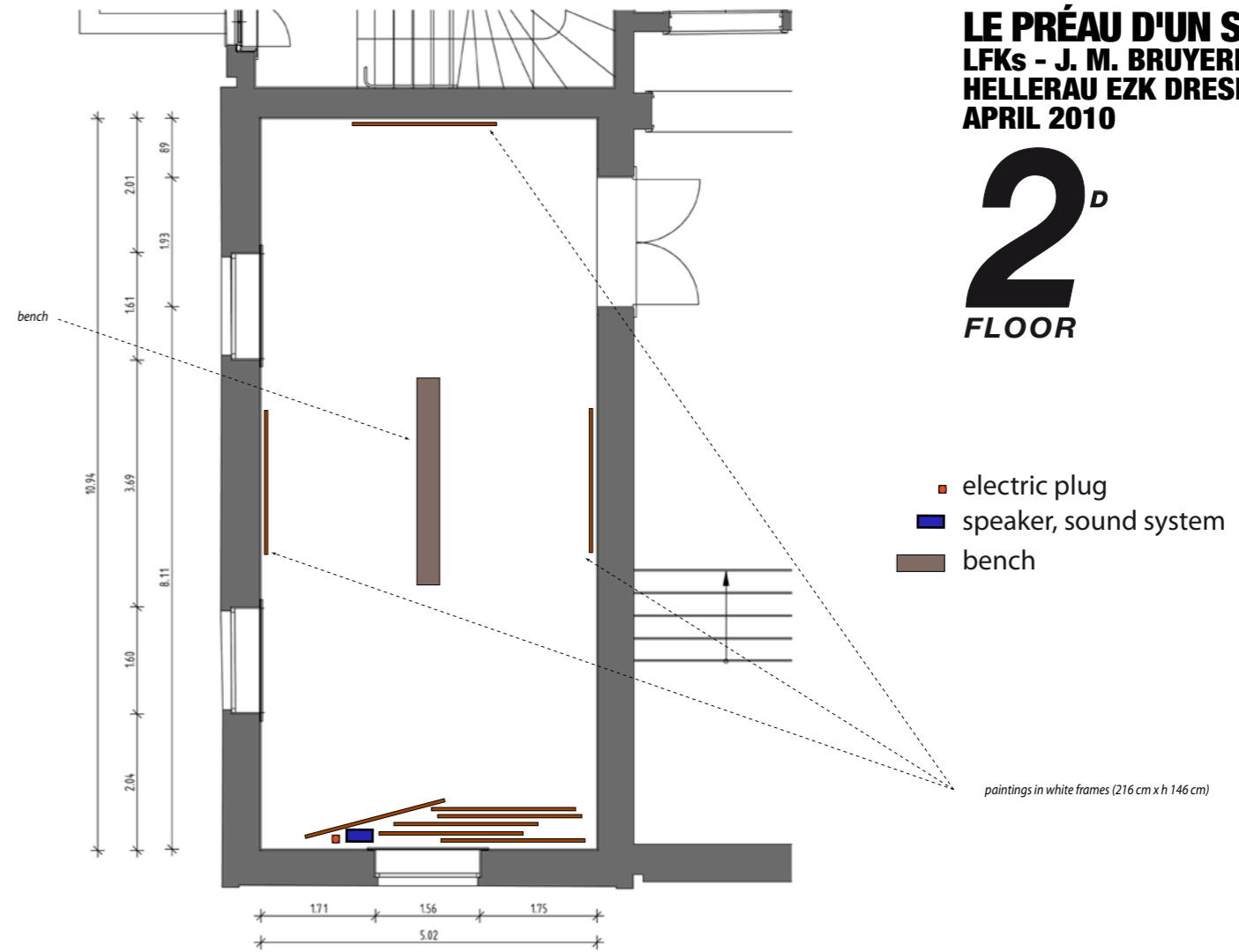
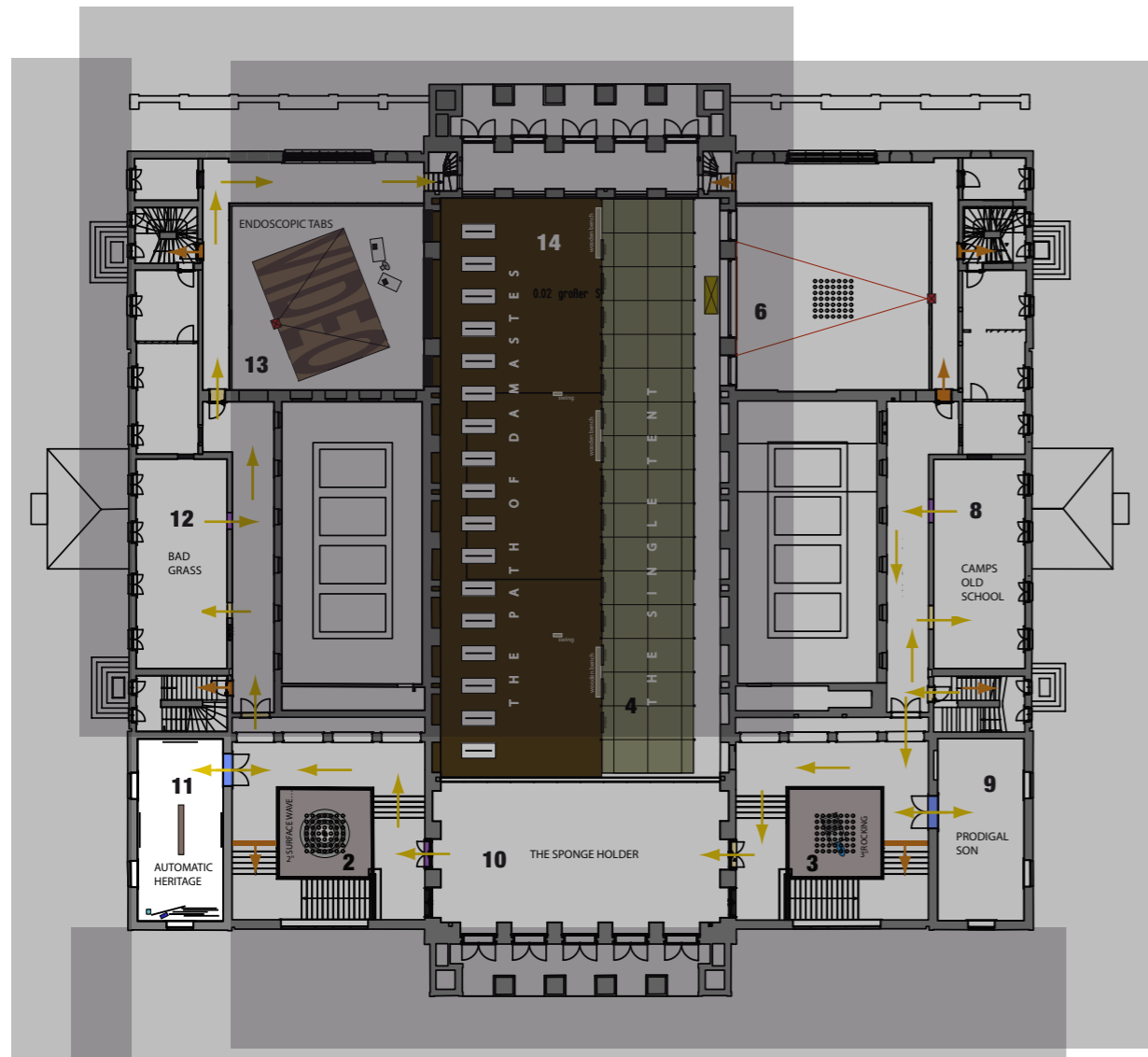

**AUTOMATIC HERITAGE**



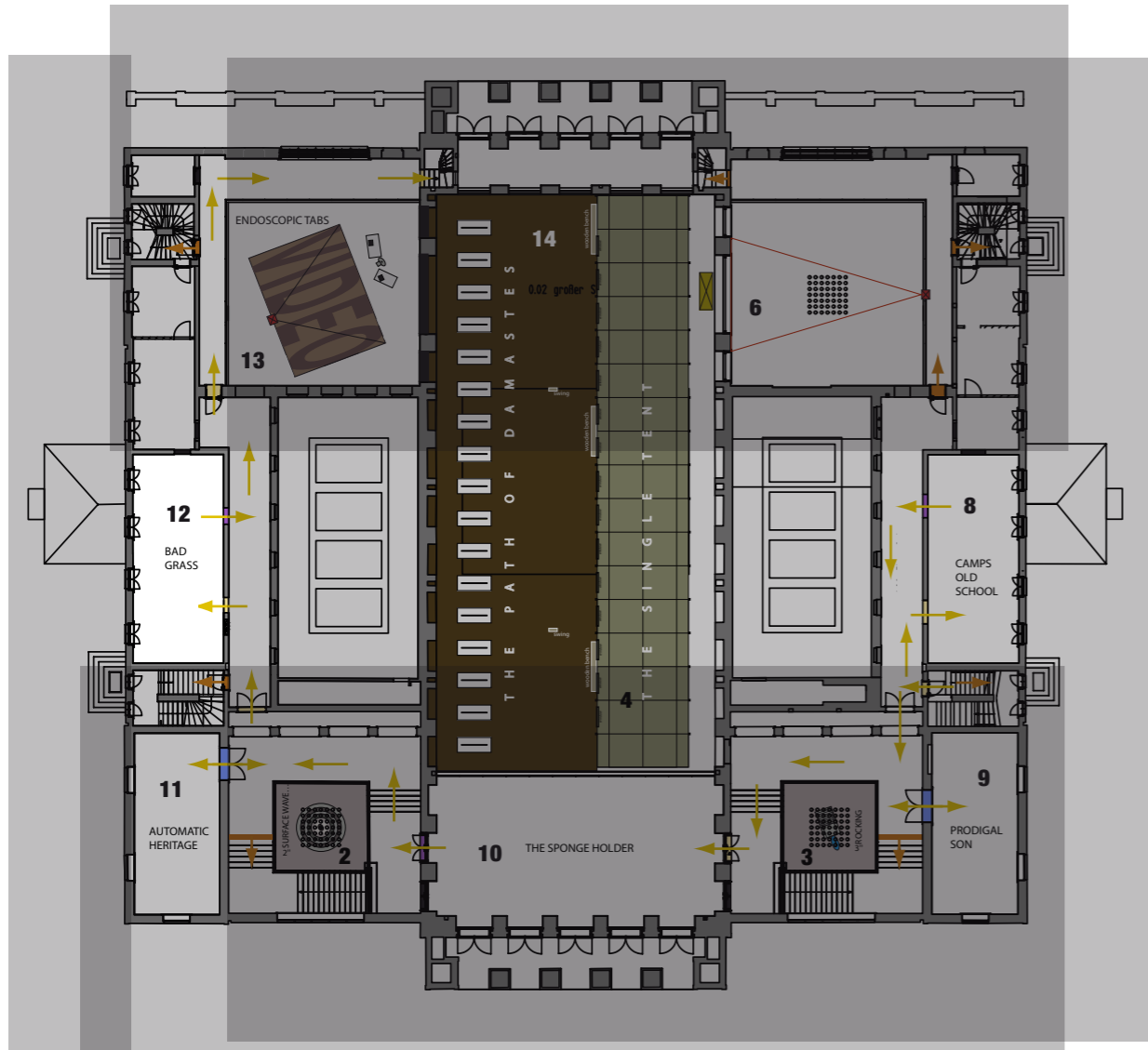

**LE PRÉAU D'UN SEUL**  
**LFKs - J. M. BRUYERE**  
**HELLERAU EZK DRESDEN**  
**APRIL 2010**

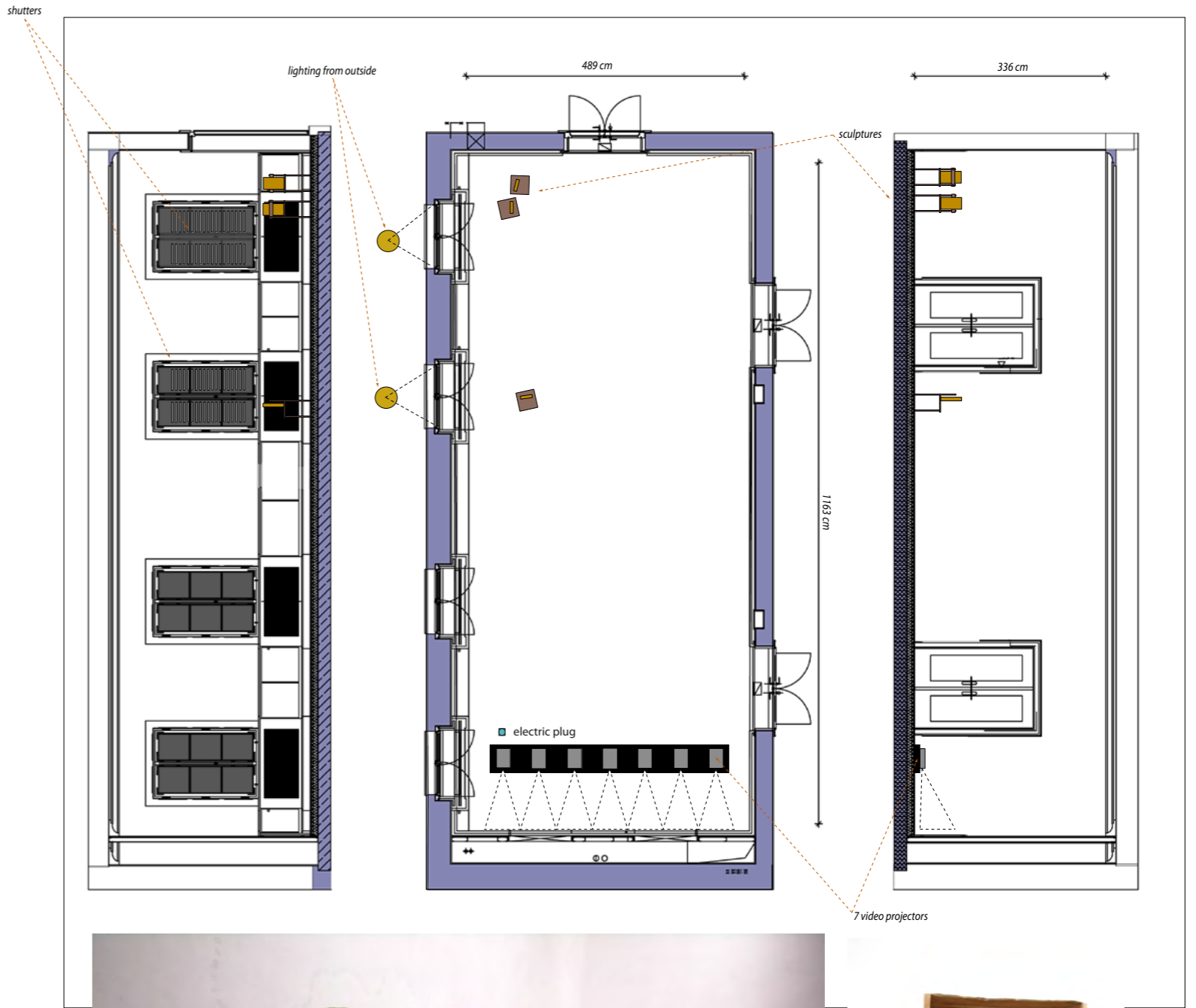

# 12

**BAD GRASS**

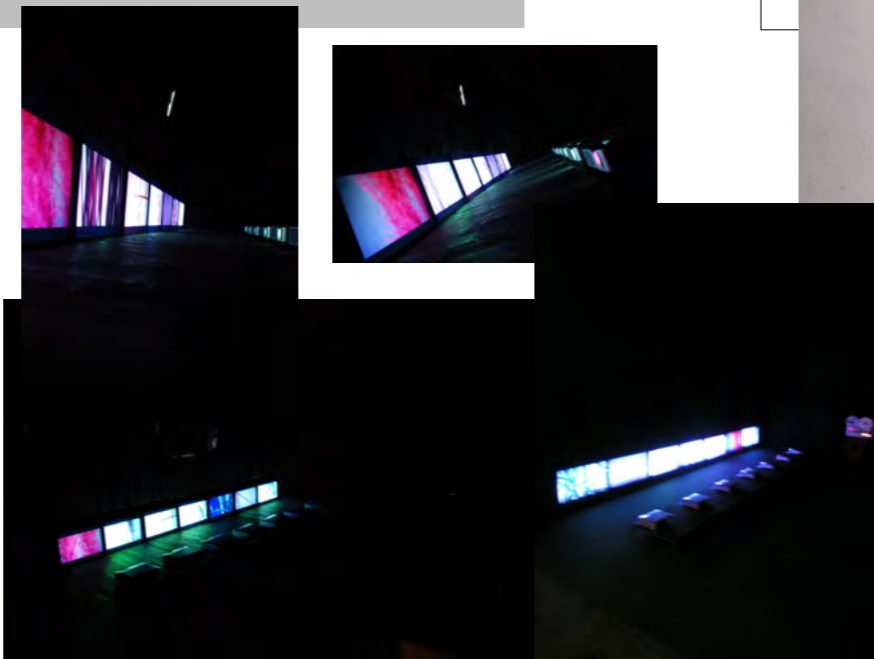

**2<sup>D</sup>**  
**FLOOR**

**West corridor Second Floor to West and North-West Gallery up on Main Hall-side stage West**



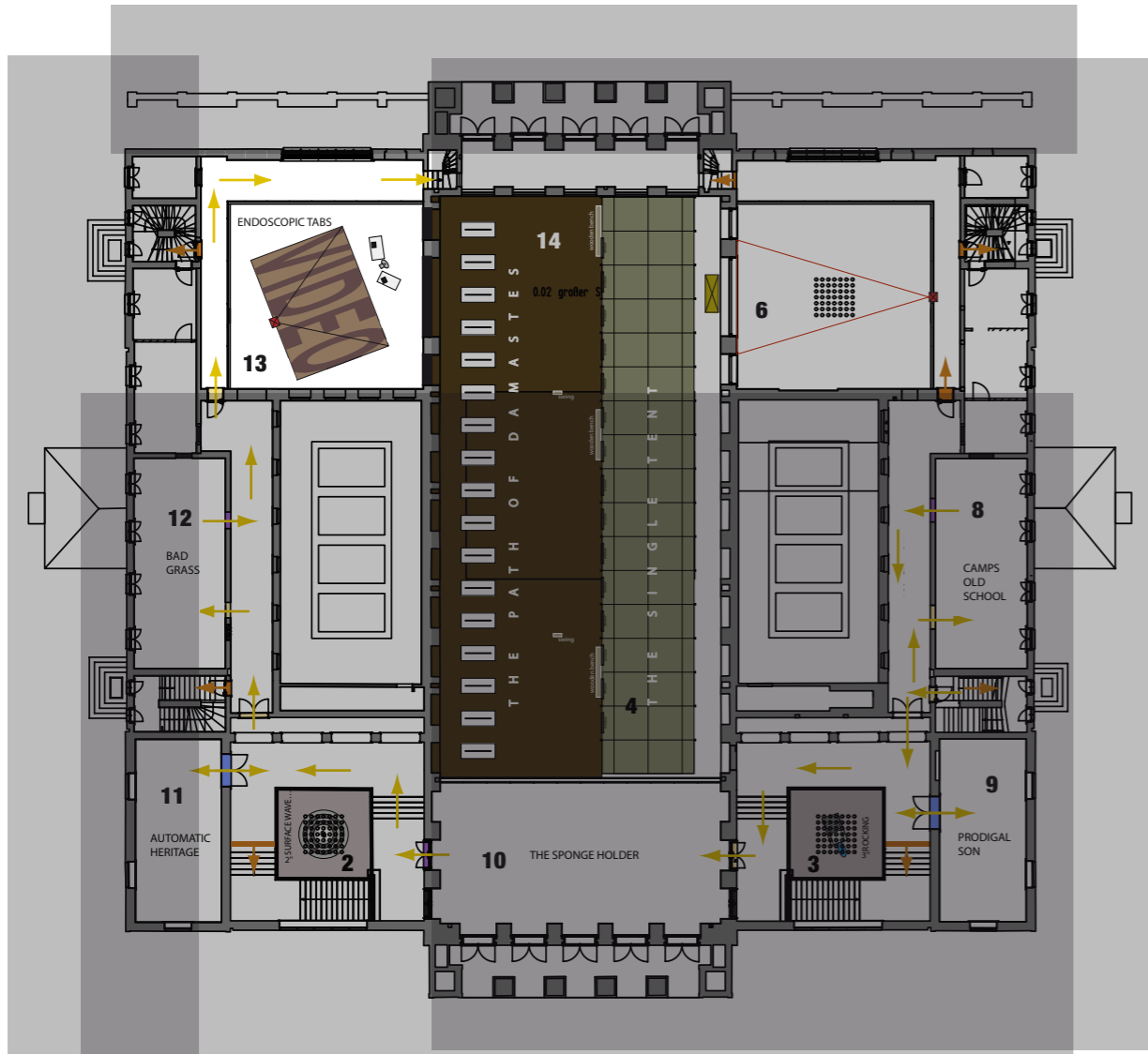

**LE PRÉAU D'UN SEUL**  
**LFKs - J. M. BRUYERE**  
**HELLERAU EZK DRESDEN**  
**APRIL 2010**

# 13

ENDOSCOPIC TABS

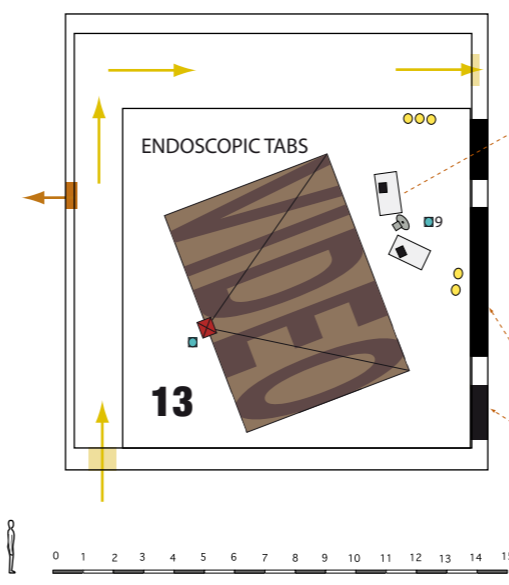

- lighting
  - electric plug
  - video projector (large screening on the floor, from up) (to be provided on location)
- all dvd players (10) + sound system on first floor, in room 14'
- partitions ( first floor. People can't get in this room, but pass by the gallery on second floor)

**2<sup>D</sup>**  
**FLOOR**

**End of North-west gallery, stairs down to Main Hall, North side**







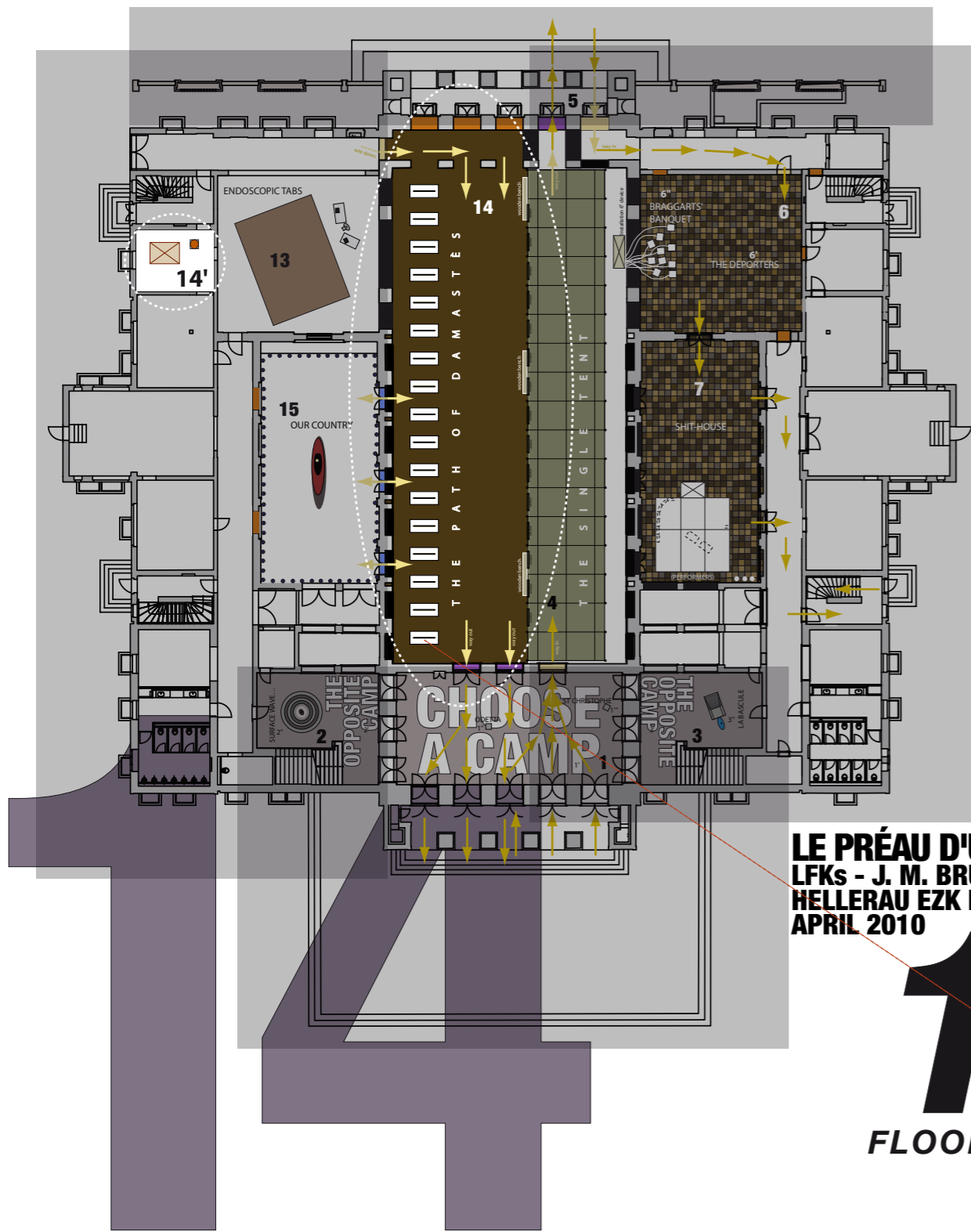

**LE PRÉAU D'UN SEUL**  
**LFKs - J. M. BRUYERE**  
**HELLERAU EZK DRESDEN**  
**APRIL 2010**

**1** RST  
**FLOOR**

**THE PATH OF DAMASTES**

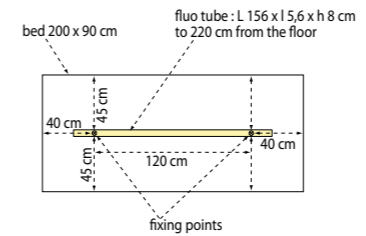
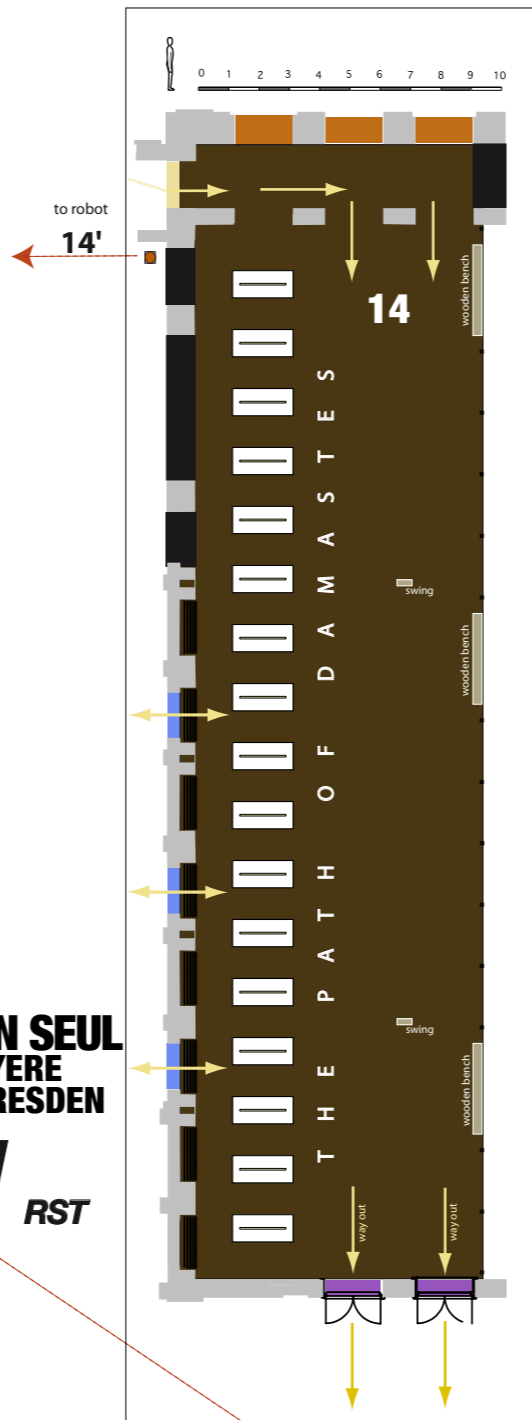

- 17 medical beds
- 17 speakers
- 17 fluo tubes
- 2 swings
- 3 benches

- dead leaves (38 m<sup>3</sup>)

- ⊠ robot, sound system, computers
- electric plug 16A mono
- fluo tube
- added partitions

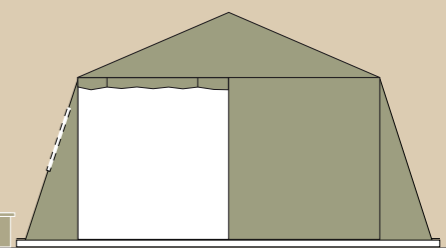
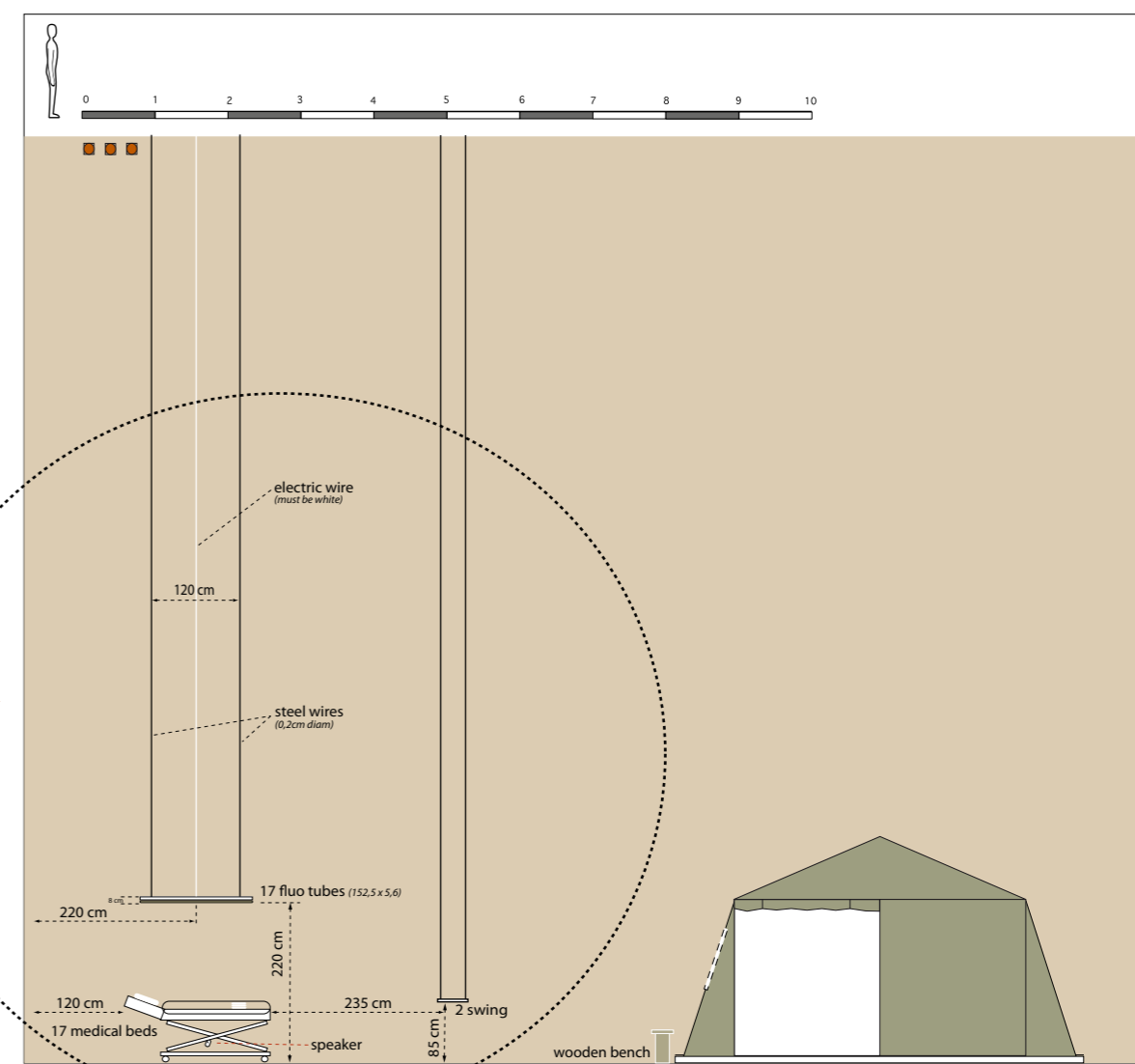



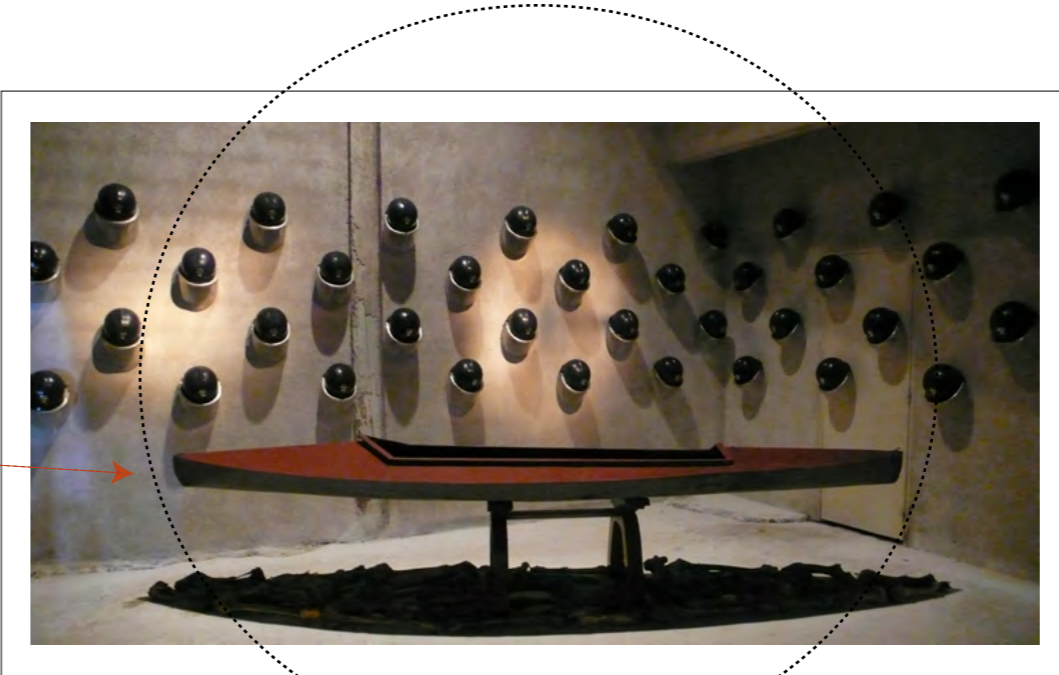
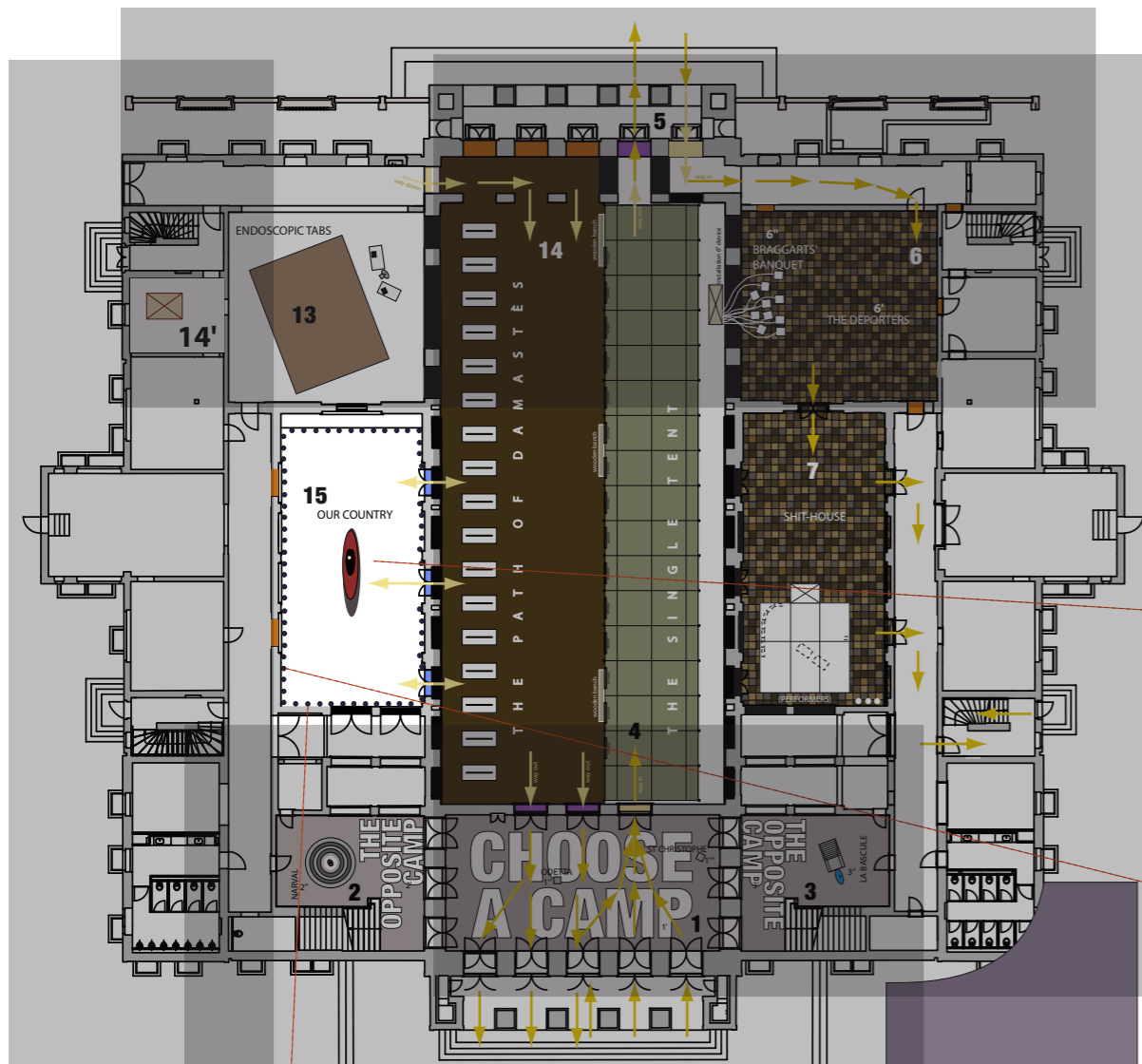

OUR COUNTRY



LE PRÉAU D'UN SEUL  
LFKs - J. M. BRUYERE  
HELLERAU EZK DRESDEN  
APRIL 2010

1<sup>RST</sup>  
FLOOR

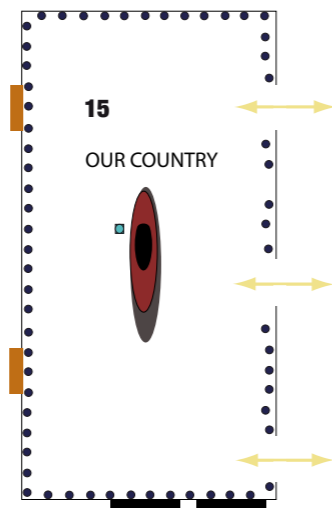

- pirogue
- bones
- shadow
- 78 republican guard helmets

- electric plug
- added partition
- emergency exit

including *The Immigrant Song* by Led Zeppelin (1972)  
+ using the lighting system of the room itself



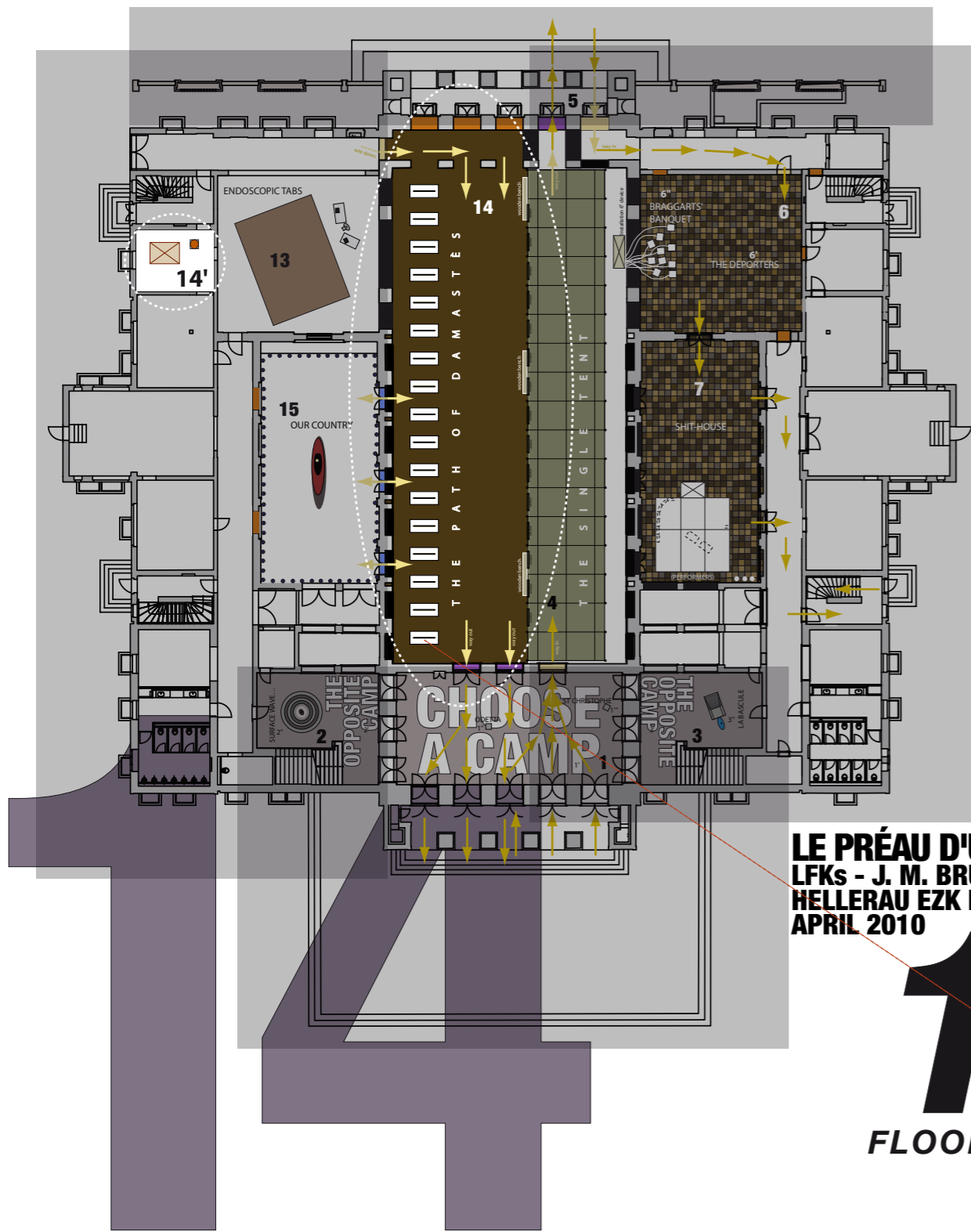

**LE PRÉAU D'UN SEUL**  
**LFKs - J. M. BRUYERE**  
**HELLERAU EZK DRESDEN**  
**APRIL 2010**

**1** RST  
**FLOOR**

**THE PATH OF DAMASTES**

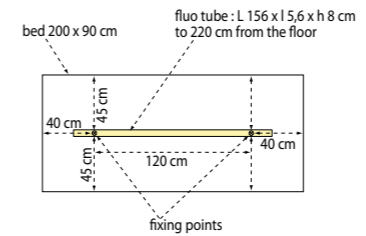
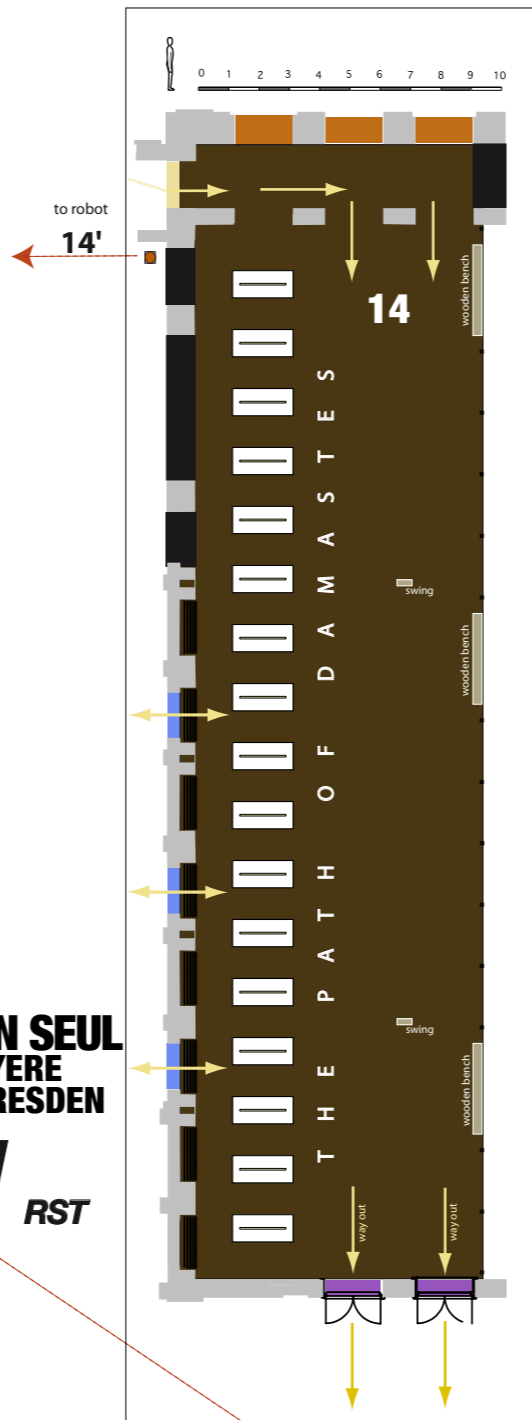

- 17 medical beds
- 17 speakers
- 17 fluo tubes
- 2 swings
- 3 benches

- dead leaves (38 m<sup>3</sup>)

- ⊠ robot, sound system, computers
- electric plug 16A mono
- fluo tube
- added partitions

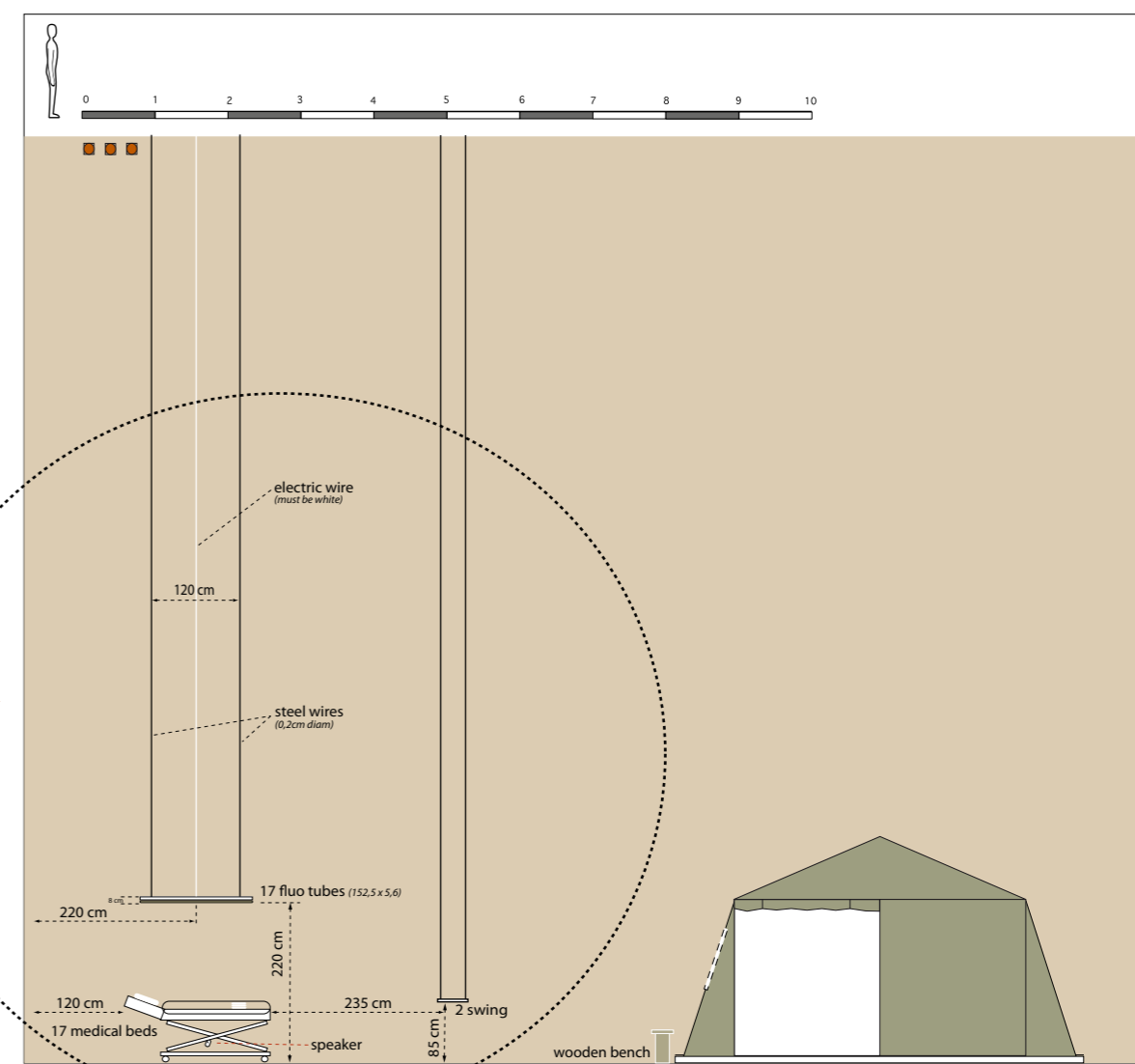



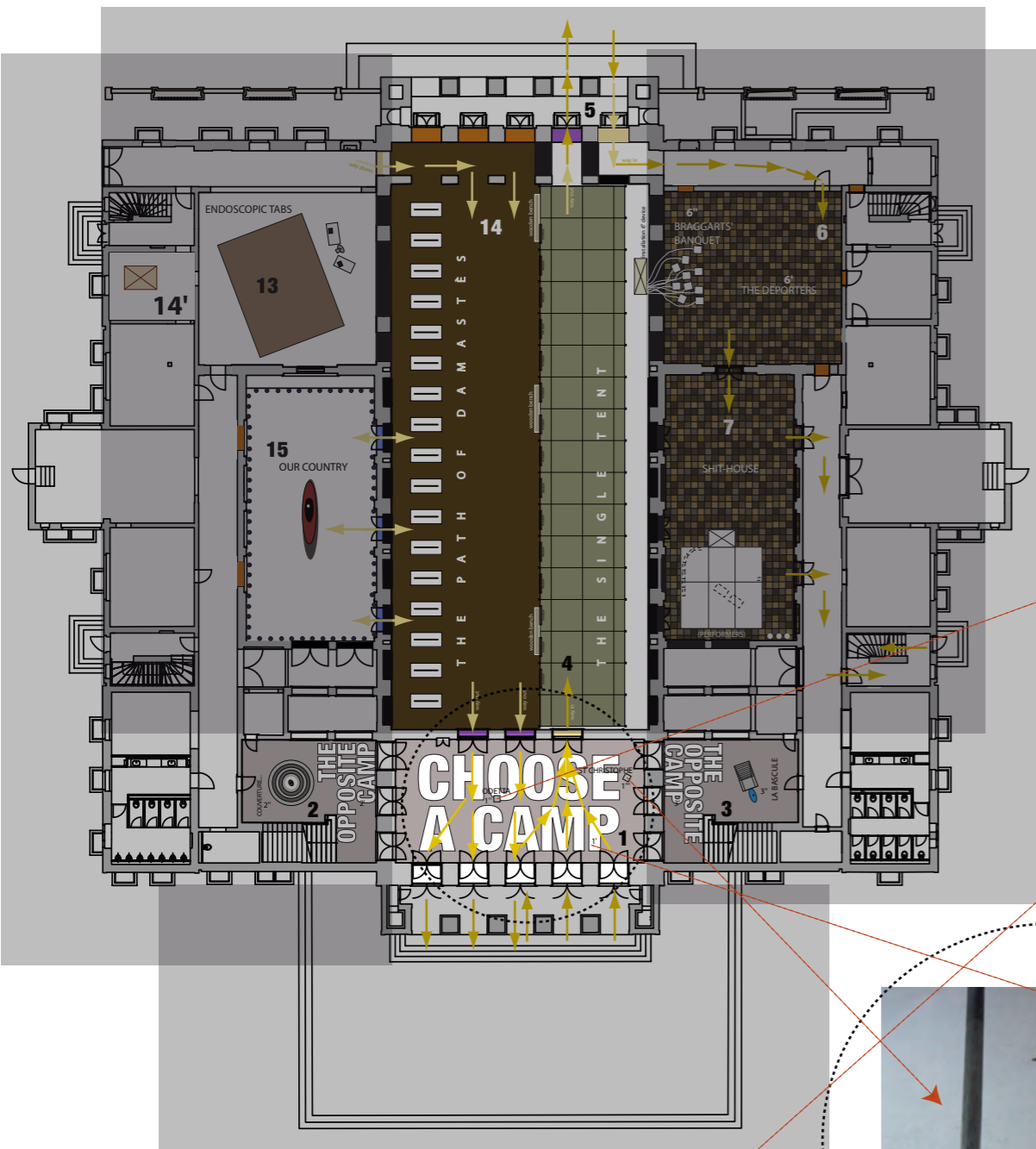

# CHOOSE A CAMP

- sound system
- electric plug (monitor + palyer dvd)
- 1' text on the floor
- 1" Odetta + The Earth (vidéo)
- 1" Saint-Christophe de Décathlon (sculpture)



## CHOOSE A CAMP

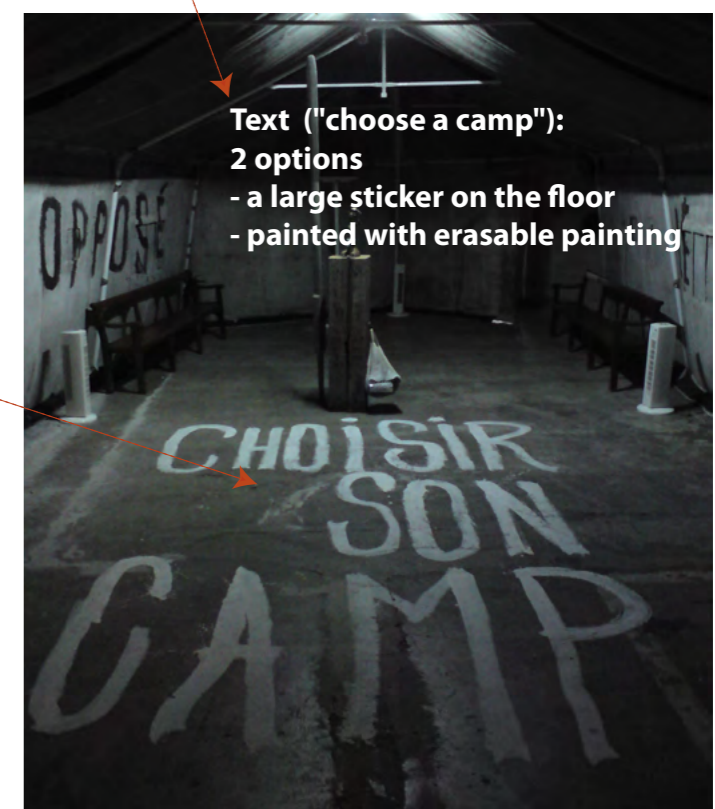

Text ("choose a camp"):  
 2 options  
 - a large sticker on the floor  
 - painted with erasable painting

**LE PRÉAU D'UN SEUL**  
**LFKs - J. M. BRUYERE**  
**HELLERAU EZK DRESDEN**  
**APRIL 2010**

**1** <sup>RST</sup>  
**FLOOR**

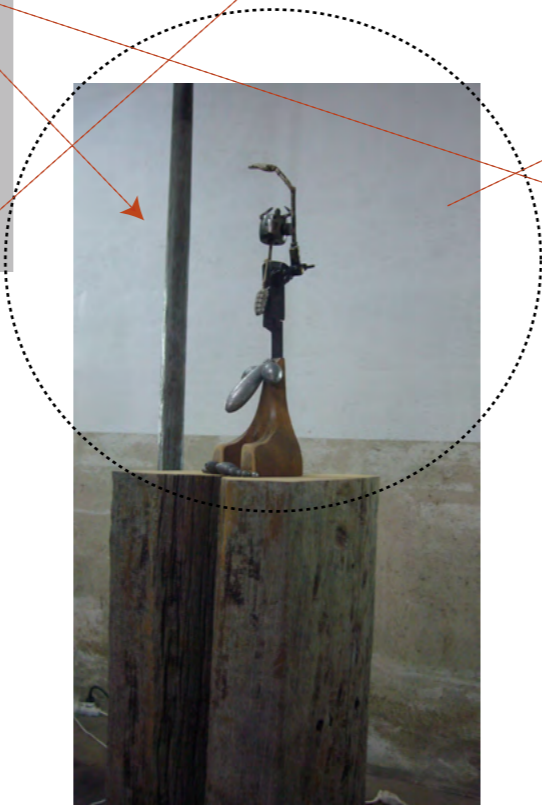
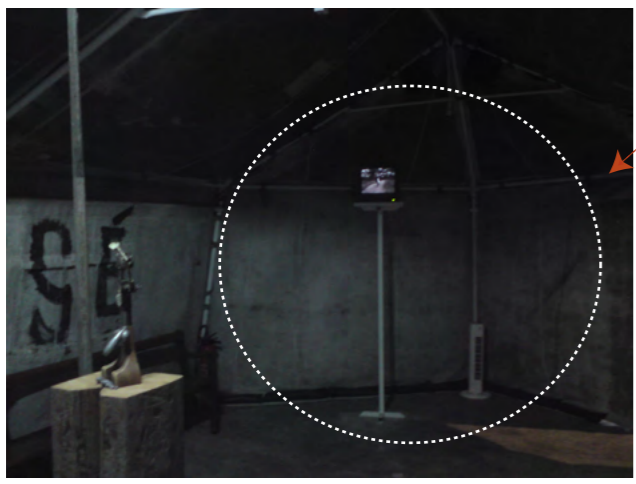

**Way out of the show (or back to room 4)**















